

Pos. Nr. Pos. no.	Beschreibung Description	Art.-Nr. Art. no.	Preisgruppe Price bracket
1	Heizer Heater	89725	5
2	E-Lokführer Loco driver	89726	5
3	Lichtleiter-Fenstersatz Light transmission bar	110637	20
4	Teilesatz Part set	110673	12
5	Kesselleitungsatz Boiler set	110674	12
6	Lokgewicht Sound Loc weight sound	110878	10
7	Lautsprechergehäuse Speaker body	110879	6
8	Teilesatz Part set	111219	7
9	Griffstange FH Handrail drivers cab	111221	2
10	Schaltstange rechts Switch rod right	111222	12
11	Teilesatz Part set	111223	7
12	Teilesatz Part set	111234	13
13	Teilesatz Part set	111235	10
14	Teilesatz Part set	111241	12
15	Teilesatz Part set	111242	7
16	Griffstangensatz Handrail set	111247	12
17	Sanddomstange Sand dome rod	111293	4
18	Pumpenhebel lang Pump lever long	111533	2
19	GF-Schraube M2x6 GF-Screw M2x6	114828	2
20	Teilesatz Part set	117111	4
21	Führerstandsboden Driver cab bottom	117112	13
22	Führerhaus komplett Driver cab assembly	117121	43
23	Pumpensteckteil Pump	117122	2
24	Umlaufblechsatz Gangway set assembly	117123	35
25	Domdeckel 1 m. Ring Dome	117124	2
26	Führerhausfenster links Driver cab window left	117128	3
27	Griffstange Führerhaus Handrail Driver cab	117130	3
28	Kessel komplett Betr.Nr. 18 314 Boiler assembly loco no 18 314	117391	70

Änderungen in Konstruktion und Ausführung vorbehalten
We reserve the right to change the construction and specification

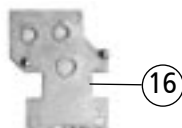

Pos. Nr. Pos.no.	Beschreibung Description	Art.-Nr. Art.no.	Preisgruppe Price bracket
1	Schraube M 1.6X4 schw. Screw M 1.6X4 black	85727	2
2	Beilagscheibe Washer disc	86108	2
3	Schneckenzahnrad doppelt Worm gear	86419	4
4	Zwischenzahnrad Gear	86480	2
5	Puffer flach Buffer flat	88556	4
6	Puffer gewölbt Buffer vaulted	88557	4
7	Lager für Schneckenachse Worm bearing	89749	6
8	Drahtlampe Light bulb	106755	10
9	Kardanschale lang Cardan dish long	109248	4
10	Zahnrad Z=16 Gear Z=16	109251	2
11	Schneckensatz Worm set	110656	24
12	Kardanwelle Cardan shaft	110665	4
13	Lokplatine komplett Printed circuit assembly	110875	49
14	Kesselstützensatz Boiler holder set	111233	7
15	Seutheisolierung Seuthe insulating	111239	2
16	Lokgetriebedeckel Gear cover	111251	20
17	Kolbenschutzrohr Cylinder protection tube	111253	2
18	GF-Schraube 1,6x6 GF-screw 1,6x6	114836	2
19	SK-Schraube M2x4 SK-screw M2x4	115541	2
20	Steuerung komplett Steering assembly	117110	73
21	Linse klein Reflector small	117118	2
22	Lokgrundrahmen Loco underbottom	117119	21
23	FK-Schraube m. gewinde FK-screw with thread	117120	2
24	Lackierte Zylinderblockbaugr. Coated Cylinderblock assembly	117125	27

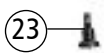
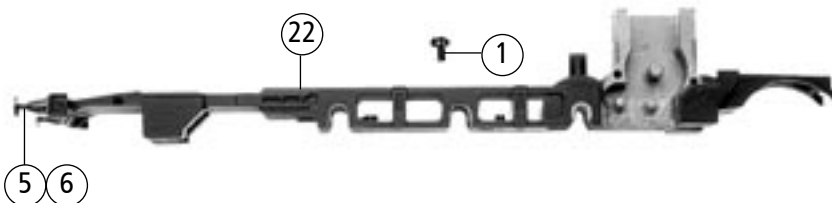
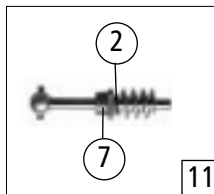
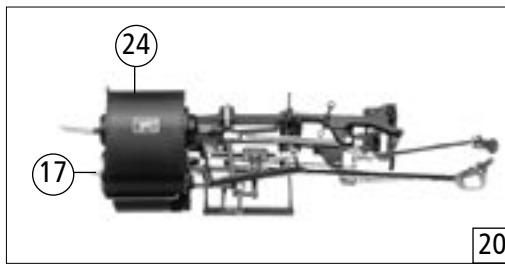
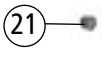
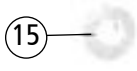
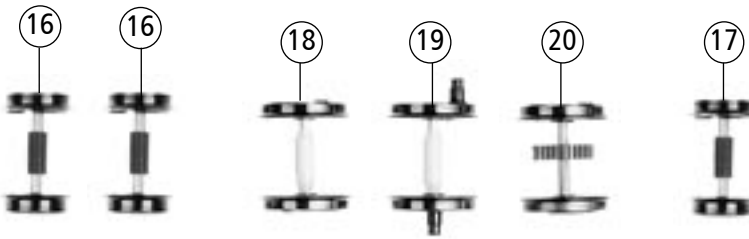
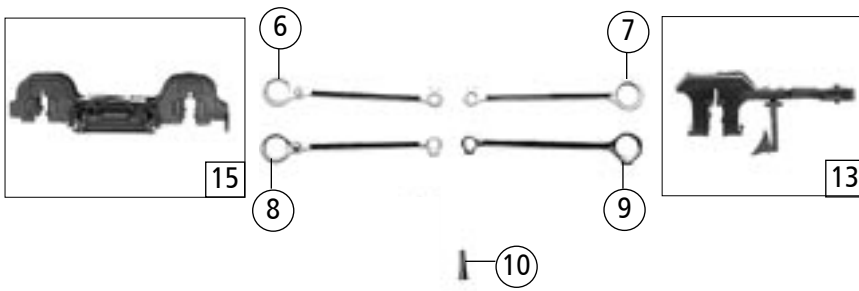

5 o. Abb. / no ill.
Nachlaufgestellfeder
Teil wheelset Spring

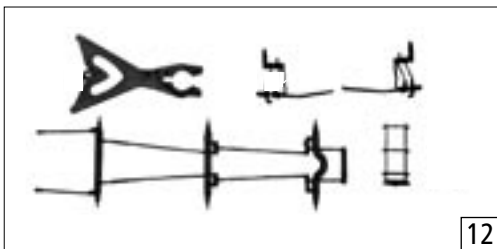
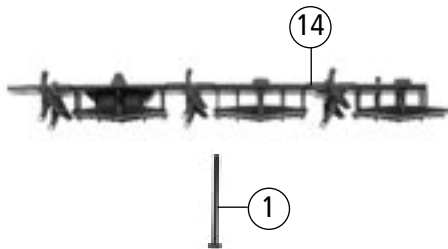

41252		DB	18 ⁴	=	🔊	□
Pos. Nr. Pos.no.	Beschreibung Description	Art.-Nr. Art.no.	Preisgruppe Price bracket			
1	Schraube M2x18 Screw M2x18	85679	3			
2	Kupplungsfeder für Vorlaufgestell Couplingspring	86201	2			
3	Zugfeder Spring	86208	2			
4	Tachowelle Nierosta Speedometer shaft Nirosta	110663	3			
5	Nachlaufgestellfeder o. Abb. Teil bogie spring no ill	110893	3			
6	Kuppelstange bedruckt Connecting rod printed	111214	9			
7	Kuppelstange bedruckt Connecting rod printed	111215	9			
8	Kuppelstange bedruckt Connecting rod printed	111216	9			
9	Kuppelstange bedruckt Connecting rod printed	111217	9			
10	Bolzen Pin	111218	2			
11	Scheibe Washer	111220	2			
12	Teilesatz Part set	111224	15			
13	Nachlaufgestell o. Radsatz Teil bogie without wheelset	111246	10			
14	Lokboden Frame	111250	20			
15	Vorlaufgestell o. Radsatz Pilot frame without wheelset	111254	16			
16	Vorlaufradsatz Pilot wheelset	111255	14			
17	Nachlaufradsatz Teil wheelset	111256	14			
18	Radsatz 1 Wheelset 1	111257	20			
19	Radsatz 2 Wheelset 2	111258	20			
20	Radsatz 3 Wheelset 3	111259	20			

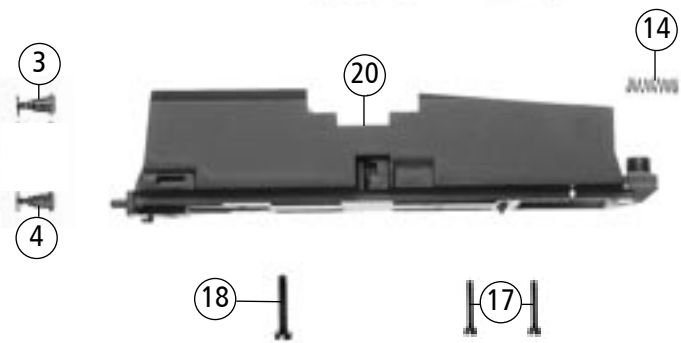
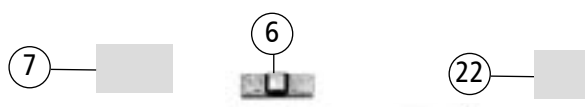
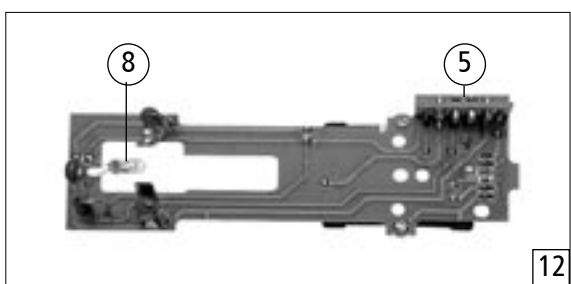
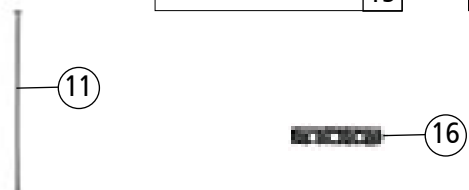
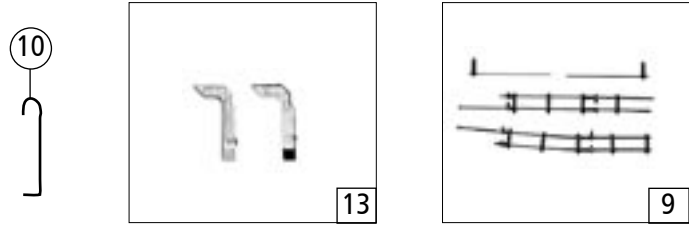
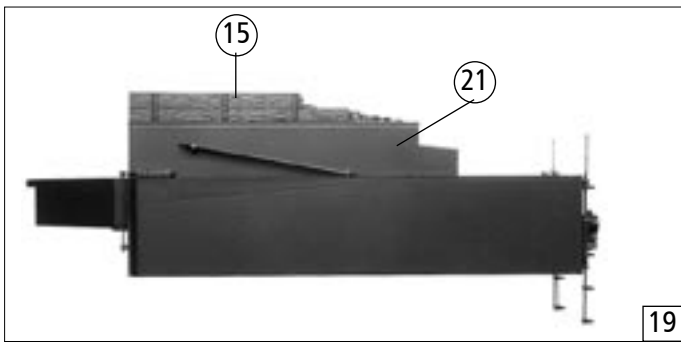

41252 18⁴

Pos. Nr. Pos.no.	Beschreibung Description	Art.-Nr. Art.no.	Preisgruppe Price bracket
1	Motor Motor	85132	57
2	Kardanschale kurz Cardan bearing	87129	3
3	Puffer flach Buffer flat	88556	4
4	Puffer gewölbt Buffer vaulted	88557	4
5	Brückenstecker Connector	100644	7
6	Motorspannblock Engine block	110633	2
7	Etikette-Silber Etiquette-silver	108697	2
8	Drahtlampe T1 16V/30mA Light bulb T1 16V/30mA	109321	10
9	Ts.-Tender Part set tender	110639	12
10	Türfeder o. Abb. Door spring no ill	110640	3
11	Drahtstift Wire pin	110641	3
12	Tenderplatine kopmplett Printed circuit, tender	110669	51
13	Tenderlichtleiteratz Light transmission set	110672	7
14	Druckfeder Spring	110690	3
15	Kohleneinsatz Coal insert	110691	6
16	Platinenniederhalter Circuit board	111227	3
17	GF-Schraube 1,6x6 GF-screw 1,6x6	114836	2
18	GF-Schraube 1,6x10 GF-screw 1,6x10	114881	2
19	Tendergehäuse komplett Tender body assembly	117116	55
20	Tendergrundrahmen Tender frame	117117	19
21	Tenderoberteil Tender top	117126	17
22	Etikette silber 12x12 mm Etiquette silver 12x12mm	117127	2



16 o. Abb. / no ill.
Getriebe komplett
Gear assembly

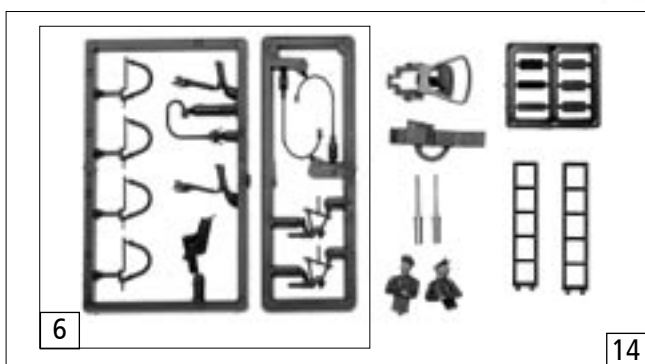
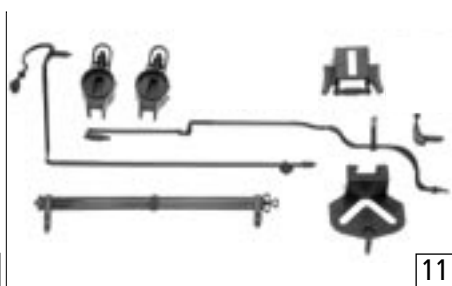
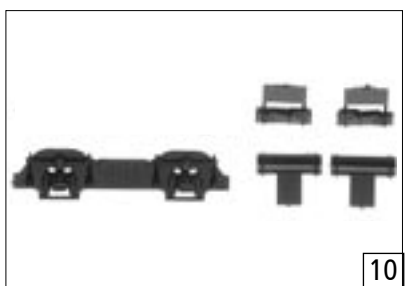
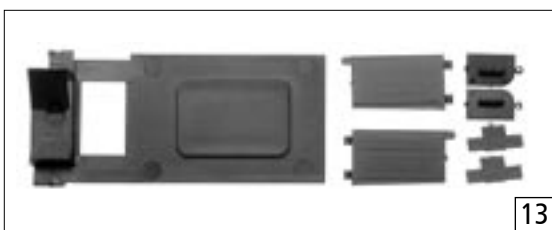
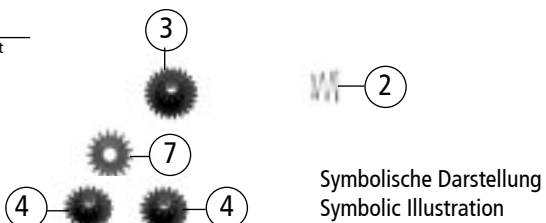

Pos. Nr. Pos. no.	Beschreibung Description	Art.-Nr. Art. no.	Preisgruppe Price bracket
1	Hafringsatz 10Stk.10,3-12,8mm Traction tyre set 10 part 10,3-12,8mm	40069	---
2	Feder Spring	86202	2
3	Schneckenzahnrad doppelt Worm gear double	86419	4
4	Zwischenzahnrad Between gear	86480	2
5	Attrappenrahmen klein Push in part set, smal	107808	3
6	Zubehörrahmensatz Accessories set	108322	8
7	Zahnrad Z=16 Gear Z=16	109251	2
8	Radsatz mit Hafring Wheelset with traction tyre	111228	20
9	Radsatz ohne Zahnrad Wheelset without gear	111229	14
10	Teilesatz Part set	111230	20
11	Teilesatz Part set	111231	20
12	Getriebesatz Gear set	111232	28
13	Teilesatz Part set	111244	15
14	Zurüstbeutel Bag with accessories	117113	24
15	Tafelsatz Number set	117114	10
16	Getriebe komplett o. Abb. Gear assembly no ill	117115	22

Ersatzteile erhalten Sie bei Ihrem Fachhändler,
oder Ihrer Landesvertretung oder bei:

You can order your Replacement Parts at your
local dealer, your country representative or:

Roco Modellspielwaren GmbH
Kundendienst
Rifer Hauptstraße 21
A-5400 Hallein

