

17

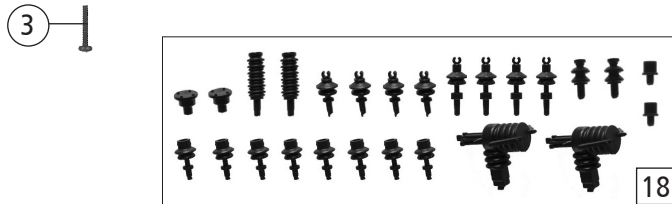

18



23

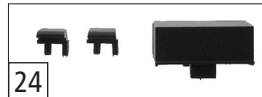

24

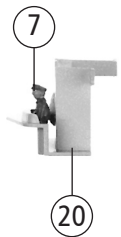

20

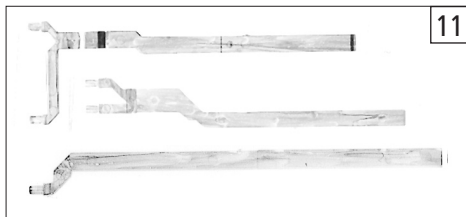

11

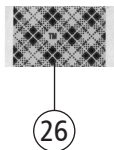

26

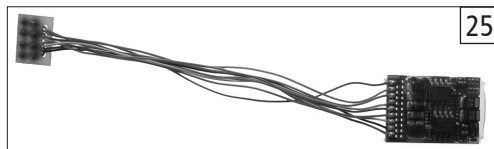

25



4



14

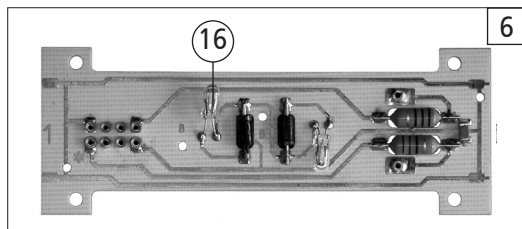

6

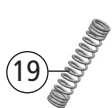

19

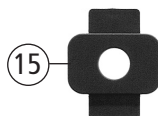

15



5

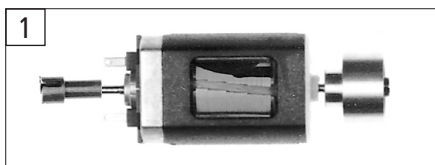

1



13

Pos. Nr. Pos.no.	Beschreibung Description	Art.-Nr. Art.no.	Preisgruppe Price bracket
62653	SJ Rc6		
68653		~	
1	Motor Motor	85117	28
2	Stromabnehmer Pantograph	85339	19
3	Schraube M2x8 Screw M2x8	85674	3
4	GF-Schraube M2x5 GF-Screw M2x5	114966	3
5	Kardanschale lang Cardan shaft long	87066	4
6	Platine kpl. Printed circuit ass.	128363	21
7	E-Lokführer E-loco driver	89732	6
8	Dachleitung 1 lackiert Roof wire 1 coated	89932	6
9	Dachleitung 2 lackiert Roof wire 2 coated	89933	7
10	Maschinenraumfenster Engine room glazing	94052	6
11	Lichtleitstäbesatz Light transmission bar set	94054	9
12	Stirnfenster Front glazing	94058	6
13	Kardanschale 8mm Cardan bearing 8mm	87152	3
14	Brückenstecker Connector	100644	6
15	Distanzplättchen Spacer	105764	3
16	Drahtlampe 16V Light bulb 16V	109321	8
17	Gehäuse kpl. Betr.nr. Rc6 1422 Body ass. loco no. Rc6 1422	134591	33
18	Isolatorsatz Part set insulator	107161	12
19	Kontaktfeder Contact spring	116876	3
20	Führerstand Drivers cab	107163	7
21	Puffer Buffer	134593	3
22	Griffstange lang Handrail long	107165	3
23	Hupe u. Stirnbügel Horn a. front holder	107162	6
24	TS-Dachaufsatz Part set louver	134592	9
AC - Wechselstrom			
25	Decoder Decoder	10884	---
26	Doppelseitiges Klebeband Doublesided adhesive tape	112629	3

Änderungen in Konstruktion und Ausführung vorbehalten
We reserve the right to change the construction and specification

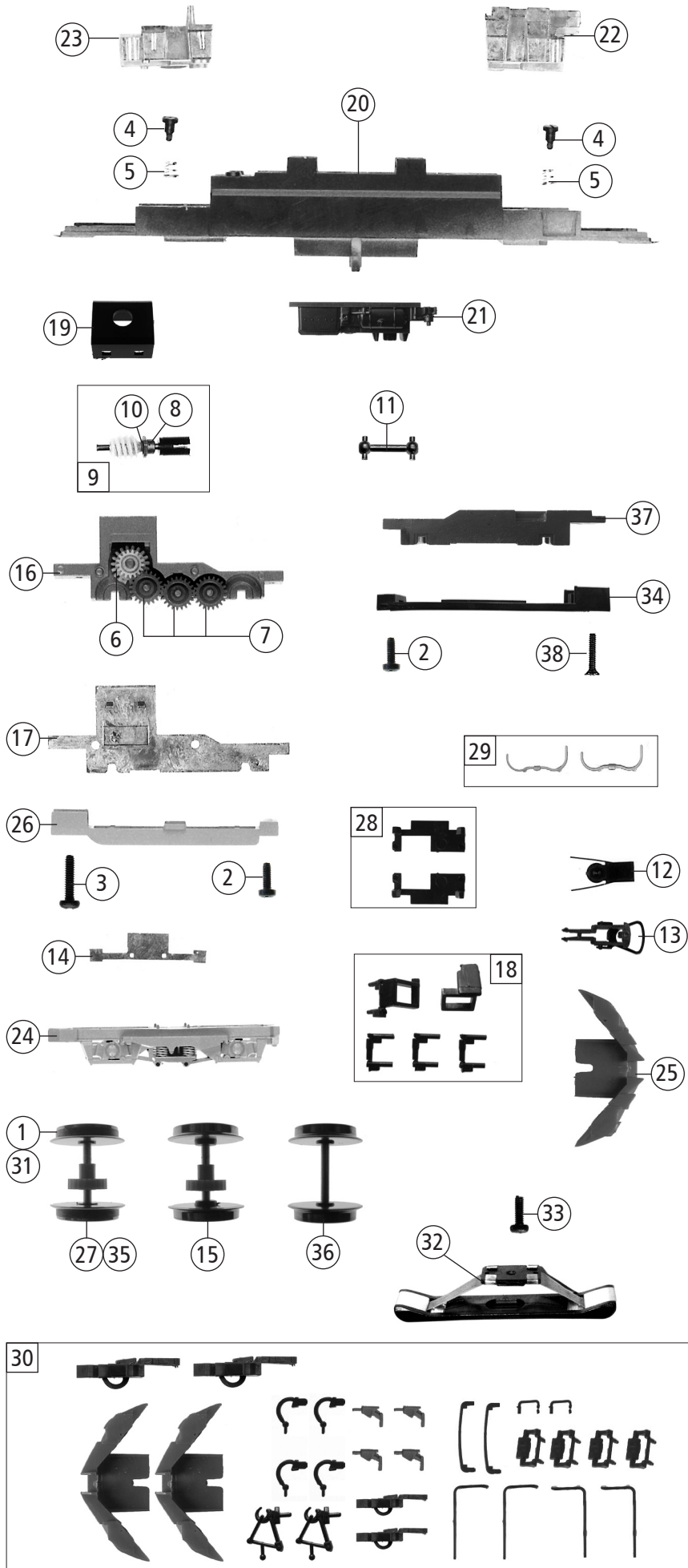

Pos. Nr. Pos.no.	Beschreibung Description	Art.-Nr. Art.no.	Preisgruppe Price bracket
62653	SJ Rc6		
68653		~	
1	Hafringsatz 10Stk. 12,9-14,6mm Set w. traction tieres 10pieces 12,9-14,6mm	40070	---
2	GF-Schraube M2x6 GF-Screw M2x6	114828	3
3	GF-Schraube M2x12 GF-Screw M2x12	114944	3
4	FK-Schraube FK-Screw	85704	4
5	Feder Spring	86202	3
6	Schnecken Zahnrad Z=17/19 gelb Worm gear Z=17/19 yellow	86413	5
7	Zahnrad Z=21 Gear Z=21	86414	3
8	Lager für Schneckenachse Bearing for worm axle	89749	6
9	Schneckensatz Worm set	86978	13
10	Beilagscheibe Washer	86108	3
11	Kardanwelle 9,5mm Cardan shaft 9,5mm	87154	3
12	Kupplungskammer Coupling chamber	134596	4
13	Standardkupplung Standard coupling	89246	6
14	Radstromkontakt Wheel current contact strip	89856	4
15	Radsatz ohne Hafring Wheelset without traction tieres	134594	11
16	Getriebekasten Gear box	93150	13
17	Getriebedeckel Gear cover	93151	8
18	TS-Blendensteckteile Part set	107158	8
19	Schneckenkammerdeckel Worm cover	107095	5
20	Grundrahmen Base frame	107149	16
21	Batteriekasten Battery box	107150	7
22	Gewicht groß Weight big	107151	12
23	Gewicht klein Weight small	112634	12
24	Blende Blind	107156	6
25	Schieneräumer Sweeper	134595	5
26	Getriebeboden Gear bottom	107159	10
27	Radsatz mit Hafring Wheelset with traction tyre	134597	12
28	Kontakthalter links u. rechts Contact holder left a. right	94062	6
29	TS-Blendensteckteile Part set	107157	6
30	Zurüstbeutel Bag with accessories	134590	17
AC - Wechselstrom			
31	Hafringsatz 10Stk. 12,5-15,3mm Set w. traction tieres 10pieces 12,5-15,3mm	40075	---
32	Schleifer 46mm Slider 46mm	86031	14
33	GF-Schraube M1,6x4 GF-Screw M1,6x4	114850	3
34	AC-Getriebeboden AC-gear bottom	122722	10
35	Radsatz m. Hafringen m. Zahnrad Wheelset w. traction tieres w. gear	134602	12
36	Radsatz o. Hafring o. Zahnrad Wheelset without traction tieres without gear	134601	10
37	Blindgetriebe Blind transmission	100988	13
38	SK-Schraube M2x10 SK-Screw M2x10	123744	3

Ersatzteile erhalten Sie bei Ihrem Fachhändler, oder Ihrer Landesvertretung:
You can order your Replacement Parts at your local dealer, your country representative: