

Pos. Nr. Pos. no.	Beschreibung Description	Art.-Nr. Art. no.	Preisgruppe Price bracket
1	Motor Motor	85060	28
2	Schraube M 2,2x9,5 Screw M 2,2x9,5	85808	3
3	Kardanschale kurz Cardan bearing, short	87129	4
4	Gelenkwelle L=10,5 Cardan shaft L=10,5	87138	4
5	Gelenkwelle L=12,5 Cardan shaft L=12,5	87174	5
6	Geländersatz Rail set	105533	10
7	TS-Fenster Part set window	131579	11
8	Drahtlampe T3/4 16V 30mA Conductor lamp T3/4 16V 30mA	108616	8
9	Platine kpl. Printed circuit assembly	112817	21
10	TS-Lichtkasten Part set light cover	200122	12
11	Auspuffkasten Exhaust pipe box	112824	3
12	Gehäuse kpl. Betr.Nr. 2256 Body ass. Loco no. 2256	131578	29
13	Führerhaus lackiert und bedruckt Drivers cab coated and printed	131581	20
14	Decoder Decoder	10884	---

Änderungen in Konstruktion und Ausführung vorbehalten
We reserve the right to change the construction and specification

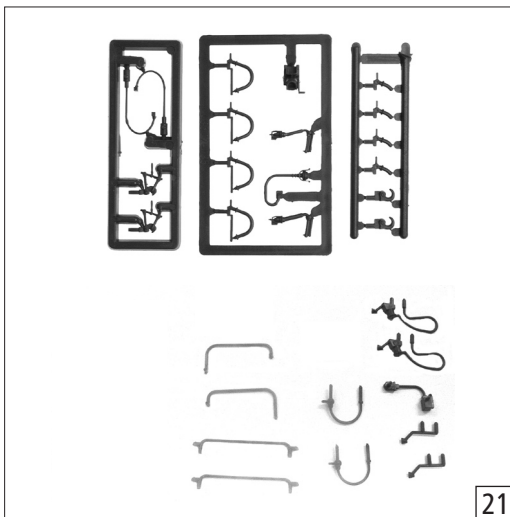
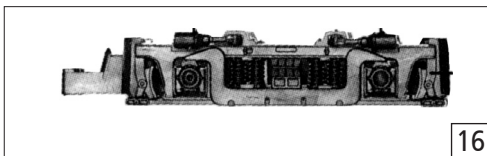
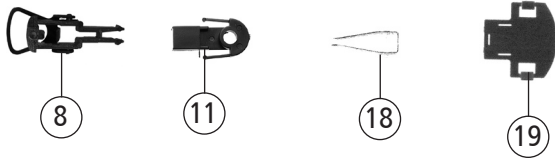
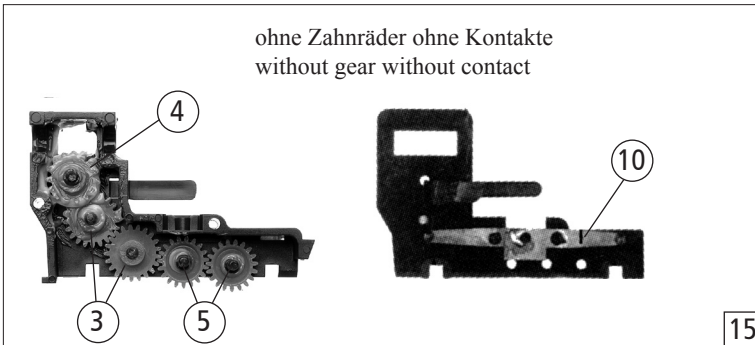
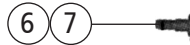
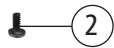
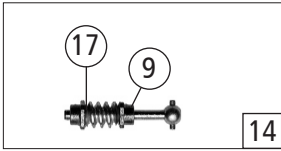
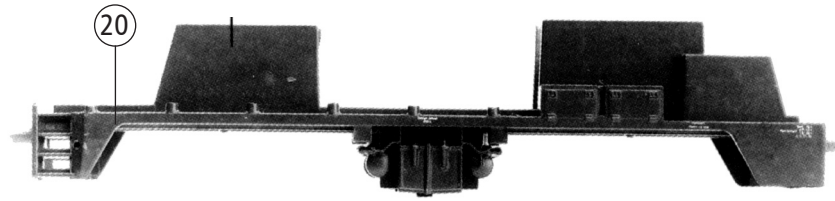

Pos. Nr. Pos. no.	Beschreibung Description	Art.-Nr. Art. no.	Preisgruppe Price bracket
1	Haftringsatz DC 10Stk. 12,5-13,8mm Traction tyres set 10pieces	40066	---
2	Schraube M 2x5 Screw M 2x5	85693	3
3	Zahnrad Z=21 Gear Z=21	86414	3
4	Schnecken Zahnrad Worm gear	86490	5
5	Zahnrad Z=19 Gear Z=19	86493	3
6	Puffer flach Buffer flat	88600	4
7	Puffer gewölbt Buffer vaulted	88601	4
8	Standardkupplung Standard coupling	89246	6
9	Lager für Schneckenachse Bearing for worm axle	89749	6
10	Radkontakt Wheel contact	89804	3
11	Kupplungskammer Couplings holder	115069	4
12	Radsatz ohne Haftring m. Zahnrad Wheelset without traction tyre w. gear	111124	11
13	Radsatz mit 2 Haftringen m. Zahnrad Wheelset with 2 traction tyre w. gear	111125	12
14	Schneckensatz Worm set	131577	19
15	Teilesatz Getriebekasten und Getriebedeckel Part set gear box and gear cap	112820	9
16	Blende mit Bremszylinder Bogie with brake cylinder	200120	10
17	Anlaufscheibe 4x2,1x0,1 Washer disc 4x2,1x0,1	113942	3
18	Stellfeder Spring	114872	3
19	Kammerdeckel Chamber cap	115070	4
20	Grundrahmen lack. u. bedruckt Base frame coated a. printed	131576	21
21	Zurüstbeutel Bag with accessories	131580	12