

Pos. Nr. Pos. no.	Beschreibung Description	Art.-Nr. Art. no.	Preisgruppe Price bracket
1	Motor Motor	85060	57
2	Schraube M 2X5 Screw M 2x5	85671	2
3	Kardanschale kurz Cardan bearing, short	87129	3
4	Gelenkwelle L=10,5 Cardan shaft L=10,5	87138	3
5	Gelenkwelle L=12,5 Cardan shaft L=12,5	87174	4
6	Geländersatz Rail set	92901	16
7	Fenster vorne Window front	92907	5
8	Drahtlampe T3/4 16V 30mA Conductor lamp T3/4 16V 30mA	108616	10
9	Platine kpl. Printed circuit assembly	112817	43
10	Glasteilesatz Gazing set	200122	20
11	Auspuffkasten Exhaust pipe box	112824	2
12	Gehäuse kpl. Betr.Nr. 2299 Body ass. Loco no. 2299	123812	57
13	Führerhaus lackiert und bedruckt Drivers cab coated and printed	123813	37
14	Lichtleiter vorne Light transmission bar in front	97666	4
15	Lichtleiter hinten Light transmission bar rear	97667	4
16	Decoder Motorola Decoder Motorola	10738	---

Änderungen in Konstruktion und Ausführung vorbehalten
We reserve the right to change the construction and specification

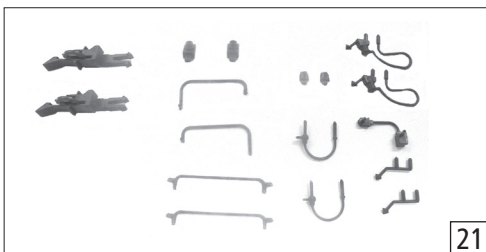
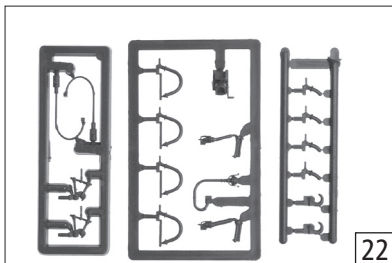
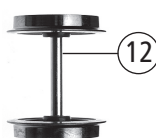
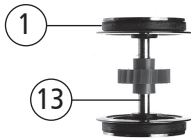
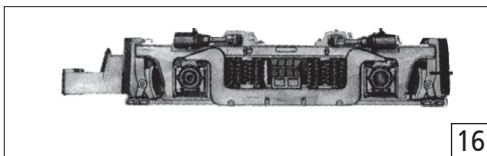
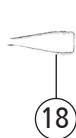
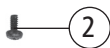
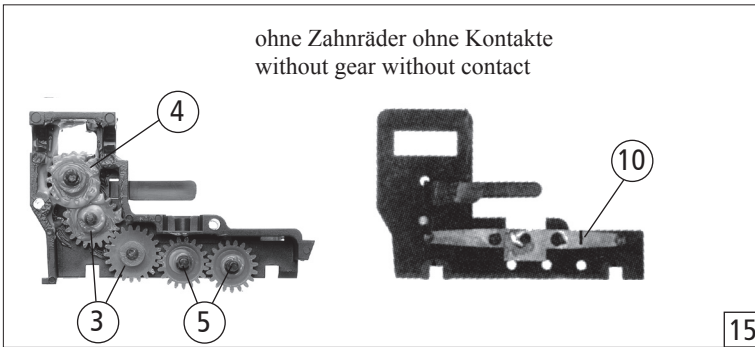
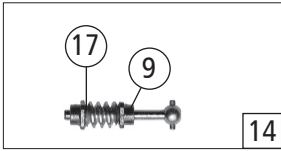
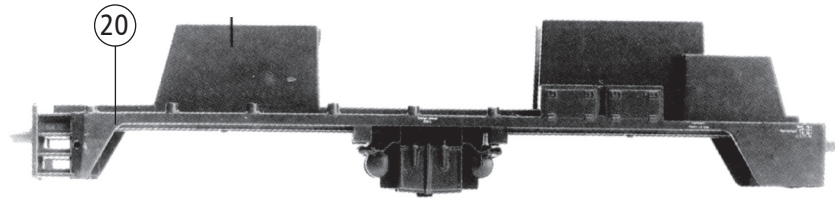

Pos. Nr. Pos. no.	Beschreibung Description	Art.-Nr. Art. no.	Preisgruppe Price bracket
1	Haftringsatz DC 10Stk. 12,5-13,8mm Traction tyres set 10pieces	40066	---
2	Schraube M 2,2x9,5 Screw M 2,2x9,5	85808	2
3	Zahnrad Z=21 Gear Z=21	86414	2
4	Schnecken Zahnrad Worm gear	86490	4
5	Zahnrad Z=19 Gear Z=19	86493	2
6	Puffer flach Buffer flat	88600	3
7	Puffer gewölbt Buffer vaulted	88601	3
8	Standardkupplung Standard coupling	89246	5
9	Lager für Schneckenachse Ex store vor worm axle	89749	6
10	Radkontakt Wheel contact	89804	2
11	Kupplungskammer Couplings holder	115069	3
12	Radsatz ohne Haftring m. Zahnrad Wheelset without traction tyre w. gear	111124	18
13	Radsatz mit 2 Haftringen m. Zahnrad Wheelset with 2 traction tyre w. gear	111125	20
14	Schneckensatz Worm set	111307	24
15	Teilesatz Getriebekasten und Getriebedeckel Part set gear box and gear cap	112820	12
16	Blende mit Bremszylinder Bogie with brake cylinder	112821	12
17	Anlaufscheibe 4x2,1x0,1 Washer disc 4x2,1x0,1	113942	2
18	Stellfeder Spring	114872	2
19	Kammerdeckel Chamber cap	115070	3
20	Grundrahmen lack. u. bedruckt Base frame coated a. printed	123811	30
21	Zurüstbeutel Bag with accessories	116788	20
22	Teilesatz Part set	116789	8