

Pos. Nr. Pos.no.	Beschreibung Description	Art.-Nr. Art.no.	Preisgruppe Price bracket
70386	CZ-SKPL RH 810		
70387			
1	Gehäuse kpl. Betr. nr. 810 210-5 Body ass. compl. Loco no. 810 210-5	148945	37
2	E-Lokführer Loco-driver	126797	6
3	TS - Sitze Part set - Seats	145428	9
4	Rahmendeckel Frame cover	145429	8
5	Leitungen Lines	145430	6
6	Inneneinrichtung Interior fittings	145427	17
7	Tritt li+re Treadle L+R	145432	6
8	Spiegel li + re Mirrors L + R	145640	5
9	Platine analog PCB analog	149113	21
10	Platine Innenbel. PCB interior lights	145150	18
11	Brückenstecker TVS PLUX-16 Jumper	133241	10
12	Motor KM Schwungm.+2 Kardansch. Motor with flywheel+2 cardan reception	145151	17
13	Kardanschale Cardan reception	145383	4
14	M-Kontaktfeder D=2,3 L=9,9 mm Contact spring	116812	3
15	TS - Fenster Part set - Windows	145386	18
16	Lichtnagel Light pin	145155	3
17	Scheibenwischer Li.+Re. Wipers L+R	145387	6
18	TS - Griffes Part set - Handles	145641	11
19	TS - Lichtnagel Part set - Light pin	145173	6
20	Kardanwelle L=20 mm Cardan shaft	100260	4
21	SK - Schraube M 1,6x4 mm SK - Screw	115161	3
Sound			
22	Platine MW f. Sound PCB	149114	18
23	Lautsprecher Loudspeaker	129524	13
24	Sounddecoder Sound decoder	147377	39

Änderungen in Konstruktion und Ausführung vorbehalten
We reserve the right to change the construction and specification

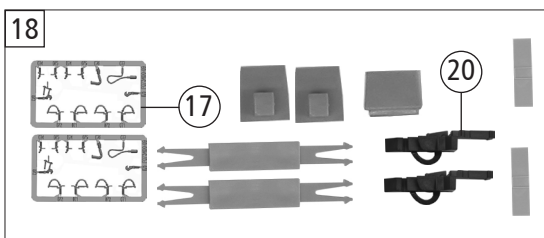
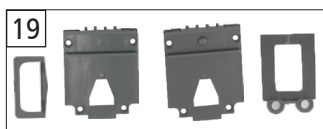
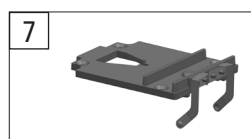
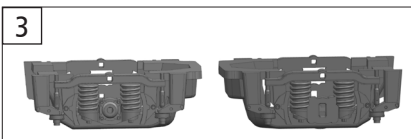
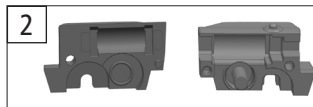
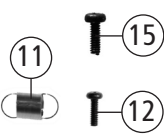
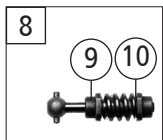
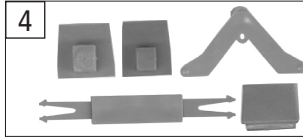
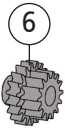
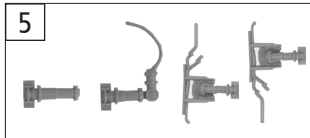
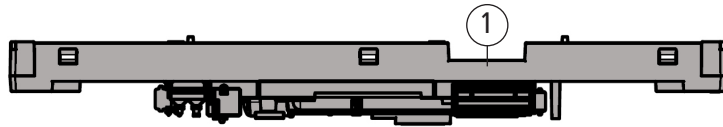

70386		CZ-SKPL	RH 810	=	
70387				=	🔊
Pos. Nr. Pos.no.	Beschreibung Description	Art.-Nr. Art.no.	Preisgruppe Price bracket		
1	Grundrahmen Base frame	145426	18		
2	Getriebeatz 2tlg. Gear set 2 parts	145137	10		
3	DG-Blende 1+2 Bogie frame	145431	10		
4	TS - Deichsel Part set - Drawbar	145635	6		
5	TS - Zylinder Part set - Cilinder	145636	7		
6	Schneckenzahnrad Z=19re./14ge. Wormgear	86416	4		
7	Radkontakt li.+re. Wheel contact L+R	145147	11		
8	Schneckenatz Worm gear set	145148	13		
9	Lager f. Schneckenachse Worm gear axle housing	89749	6		
10	Beilagscheibe 2,1x4 / 0,2 mm Washer	86108	3		
11	Zugfeder D=2,5 L=2,7/5,8 mm Draw spring	86208	3		
12	SK - Schraube M 1,6x7 mm SK - Screw	116493	3		
13	Standardkupplung Standard coupling	89246	6		
14	Radsatz m.Zahnr. o.Haftr. Wheelset w.gearwh. w/o traction tyre	145638	11		
15	GF - Schraube M 1,6x4 mm GF - Screw	114850	3		
16	Puffer Buffer	145642	4		
17	TS-Bremsschläuche und Zughaken Part set brake tubes & coupling hooks	139832	7		
18	Zurüstbeutel Bag of accesories	145614	12		
19	TS - Abdeckungen Part set - Covers	145637	7		
20	Kurzkupplung Vorentkupplung Short coupling pre-uncoupling	115550	6		