

15 o. Abb. / no ill.  
Nummertafeln  
Numberboards

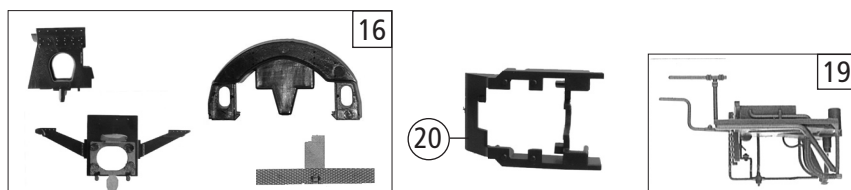

| Pos. Nr.<br>Pos.no. | Beschreibung<br>Description   | Art.-Nr.<br>Art.no. | Preisgruppe<br>Price bracket |
|---------------------|---|---------------------|------------------------------|
| 62246               | DB BR 50  | =                   |                              |
| 62247               |   | =                   | 🔊                            |
| 68247               |   | ~                   | 🔊                            |
| 1                   | Kesselboden<br>Boiler bottom  | 131135              | 12                           |
| 2                   | Steckteilesatz 2 Kessel<br>Push in part set 2 Boiler                  | 100145              | 9                            |
| 3                   | Schaltstange 0,4 x 49,7<br>Switch rod                                 | 100170              | 4                            |
| 4                   | Schaltstange 0,4 x 93<br>Switch rod                                   | 100171              | 4                            |
| 5                   | TS-Windleitblech<br>Part set smoke deflector                          | 94620               | 12                           |
| 6                   | Fensterlichtleitstäbesatz<br>Glazing light transmission set           | 100677              | 9                            |
| 7                   | Steckteilesatz 1<br>Push in parts set 1                               | 100678              | 13                           |
| 8                   | Sandfallrohr links<br>Sand gutter-pipe left                           | 132130              | 4                            |
| 9                   | GF-Schraube M2x5<br>GF-Screw M2x5                                     | 114966              | 3                            |
| 10                  | Rohre + Griffstangen<br>Tube set + Handrail set                       | 120206              | 9                            |
| 11                  | Führerhaus Betr. nr. 50 1356<br>Drivers cab Loco no. 50 1356          | 133475              | 19                           |
| 12                  | Umlaufblech lackiert u. bedruckt<br>Gangway coated a. printed         | 133476              | 16                           |
| 13                  | Kessel komplett Betr. nr. 50 1356<br>Boiler assembly Loco.no. 50 1356 | 133474              | 39                           |
| 14                  | TS-Schaltstangen<br>Part set  | 131132              | 8                            |
| 15                  | Nummertafeln (Kessel u. Tender)<br>Number boards (boiler a. tender)   | 133472              | 7                            |
| 16                  | TS-Kessel, Tender<br>Part set boiler, tender                          | 100173              | 8                            |
| 17                  | Stirnlichtleiter<br>Front light transmission bar                      | 131723              | 4                            |
| 18                  | Loklampe oben<br>Loco lamp above                                      | 100161              | 3                            |
| 19                  | Kupplungsauflegesatz<br>Coupling block set                            | 100156              | 4                            |
| 20                  | Kontaktträger<br>Contact holder                                       | 124996              | 7                            |
| 21                  | Sandfallrohr rechts<br>Sand gutter-pipe right                         | 125001              | 9                            |
| 22                  | TS - Seuthehalter,...<br>Part set seuthe holder,...                   | 125002              | 9                            |
| 23                  | Trittbrett<br>Running board   | 125005              | 7                            |
| 24                  | Kesselgewicht<br>Boiler weight  | 125011              | 8                            |
| 25                  | Sand- + Dampfdomdeckel<br>Sand- + steam cathedral covers              | 125037              | 6                            |
| 26                  | Ölkanne<br>Oilcan   | 92453               | 4                            |
| <b>Sound</b>        |   |                     |                              |
| 27                  | Lautsprecher<br>Loudspeaker   | 129524              | 16                           |
| 28                  | Kontaktstift<br>Contact pin   | 131971              | 3                            |

Änderungen in Konstruktion und Ausführung vorbehalten  
We reserve the right to change the construction and specification

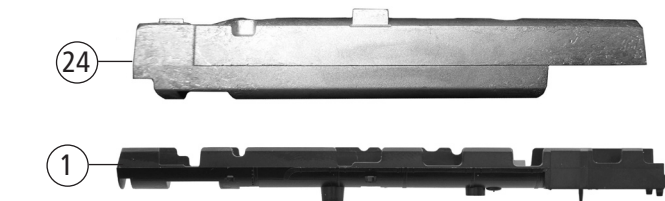
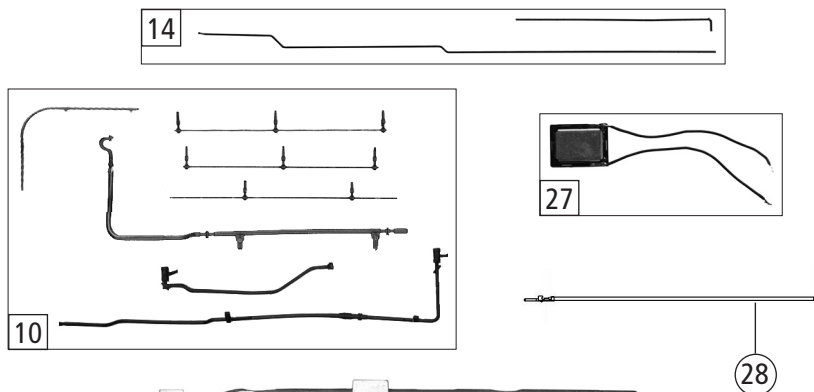
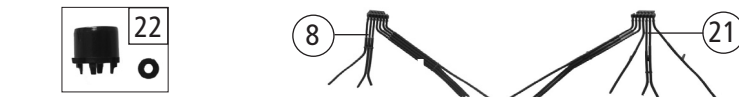
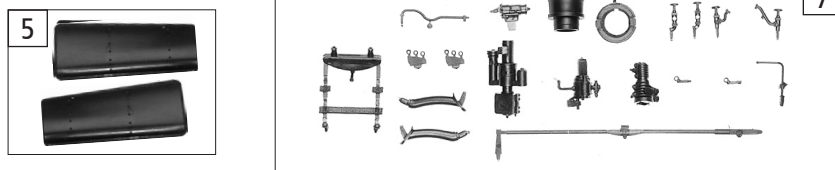
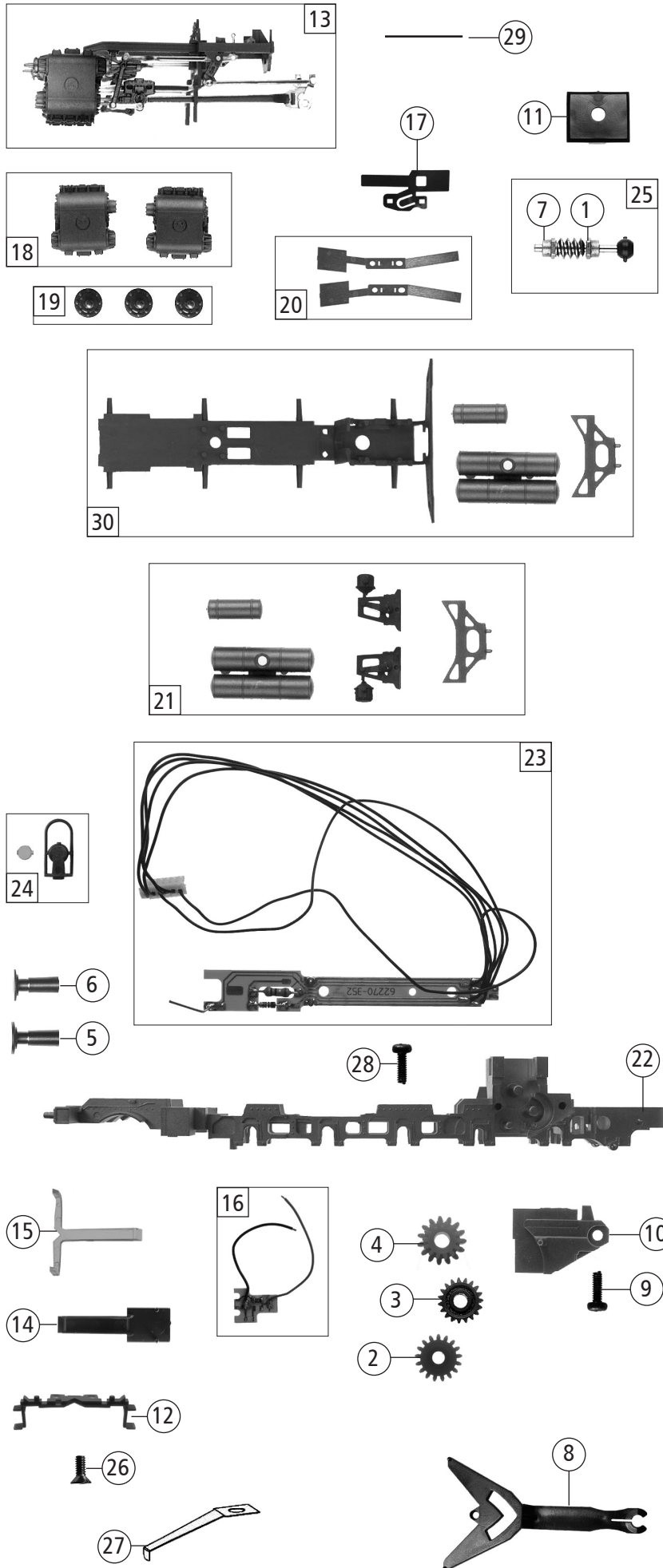

| Pos. Nr.<br>Pos.no. | Beschreibung<br>Description                                  | Art.-Nr.<br>Art.no. | Preisgruppe<br>Price bracket |
|---------------------|--|---------------------|------------------------------|
| 1                   | Beilagscheibe 2.1 x 4 / 0.2 mm<br>Washer                     | 86108               | 3                            |
| 2                   | Zahnrad Z=17<br>Gear Z=17                                    | 86409               | 5                            |
| 3                   | Zahnrad Z=19 / M0,4<br>Gear Z=19 / M0,4                      | 86417               | 3                            |
| 4                   | Schnecken Zahnrad Z=15/14<br>Worm gear Z=15/14               | 86490               | 5                            |
| 5                   | Puffer rund flach - Metall<br>Buffer round flat - metal      | 88556               | 5                            |
| 6                   | Puffer rund gewölbt - Metall<br>Buffer round vaulted - metal | 88557               | 5                            |
| 7                   | Lager für Schneckenachse<br>Bearing for worm axle            | 89749               | 6                            |
| 8                   | Lok-Tender Kupplung<br>Loco-tender coupling                  | 110211              | 8                            |
| 9                   | GF-Schraube M2x5<br>GF-Screw M2x5                            | 114966              | 3                            |
| 10                  | Lokgetriebedeckel<br>Loco gear cover                         | 109406              | 12                           |
| 11                  | Schneckenkammerdeckel<br>Worm cover                          | 111987              | 4                            |
| 12                  | Loktreppe<br>Loco step                                       | 123350              | 4                            |
| 13                  | Steuerung kpl.<br>Steering ass.                              | 108220              | 36                           |
| 14                  | Lichtabdeckung<br>Light cover                                | 122502              | 3                            |
| 15                  | Lichtleiter<br>Light transmission bar                        | 131122              | 5                            |
| 16                  | Stirn LED-Platine kpl.<br>Front LED-printed circuit ass.     | 131125              | 13                           |
| 17                  | Radkontakt<br>Wheelcontact                                   | 131126              | 5                            |
| 18                  | Zylinderblock links + rechts<br>Cylinder block left + right  | 100168              | 12                           |
| 19                  | Schiebereinsatz<br>Slidegate                                 | 92420               | 3                            |
| 20                  | Radkontakt li.+re.<br>Wheel contact le. + ri.                | 124976              | 6                            |
| 21                  | Teilesatz<br>Part set  | 107371              | 9                            |
| 22                  | Lok Grundrahmen lack.<br>Loco frame coated                   | 133469              | 16                           |
| 23                  | Lokplatine kpl.<br>Printed circuit ass.                      | 125019              | 20                           |
| 24                  | Loklampe klein<br>Loco lamp small                            | 100154              | 7                            |
| 25                  | Schneckensatz kpl.<br>Worm set ass.                          | 100132              | 13                           |
| 26                  | SK-Schraube M1,6x4<br>SK-Screw M1,6x4                        | 115161              | 3                            |
| 27                  | Vorlaufgestellfeder<br>Spring                                | 125024              | 3                            |
| 28                  | GF-Schraube M1,6x4<br>GF-Screw M1,6x4                        | 114850              | 3                            |
| 29                  | Drahtstift<br>Pin  | 110641              | 4                            |
| 30                  | Teilesatz<br>Part set  | 131722              | 10                           |

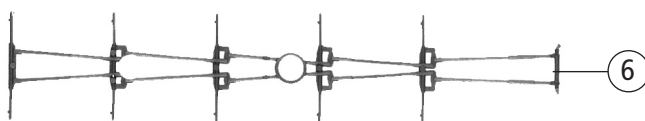
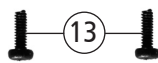
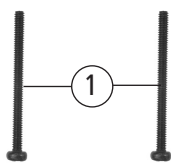
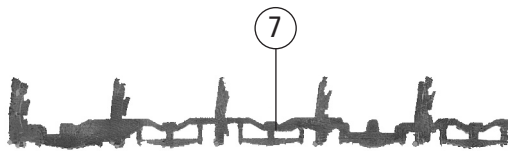
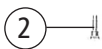
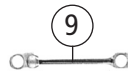
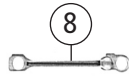
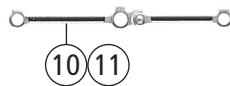
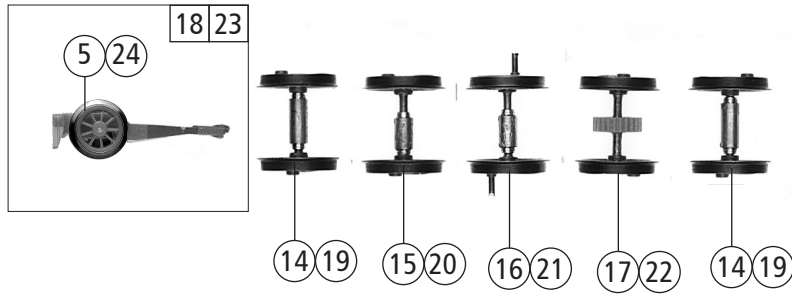

| Pos. Nr.<br>Pos.no.    | Beschreibung<br>Description                                   | Art.-Nr.<br>Art.no. | Preisgruppe<br>Price bracket |
|------------------------|---|---------------------|------------------------------|
| 62246                  | DB BR 50  |                     |                              |
| 62247                  |   |                     |                              |
| 68247                  |   |                     |                              |
| 1                      | GF-Schraube M2x25<br>GF-Screw M2x25                           | 115533              | 3                            |
| 2                      | Schraube M1,4x3,2/1.1<br>Screw M1,4x3,2/1.1                   | 85764               | 3                            |
| 3                      | Schraube M1x3,6 - sil./brün.<br>Screw M1,6x3,6                | 85765               | 3                            |
| 4                      | Distanzhülse<br>Spacer  | 86104               | 6                            |
| 5                      | Vorlaufradsatz<br>Wheelset                                    | 116384              | 9                            |
| 6                      | Bremsgestänge<br>Brake leverage                               | 100153              | 3                            |
| 7                      | Bremsrahmen<br>Brake frame                                    | 100274              | 12                           |
| 8                      | Kuppelstange links<br>Drawbar left                            | 108215              | 7                            |
| 9                      | Kuppelstange rechts<br>Drawbar right                          | 108216              | 7                            |
| 10                     | Kuppelstange mitte links<br>Drawbar middle left               | 108217              | 7                            |
| 11                     | Kuppelstange mitte rechts<br>Drawbar middle right             | 108218              | 7                            |
| 12                     | Ansatzschraube schw. vernick.<br>Screw                        | 108221              | 3                            |
| 13                     | GF-Schraube M2x4<br>GF-Screw M2x4                             | 114877              | 3                            |
| 14                     | Radsatz kleines Gewicht o.Z.<br>Wheel set small weight        | 116385              | 12                           |
| 15                     | Radsatz mit mittlerem Gewicht<br>Wheel set with middle weight | 116386              | 12                           |
| 16                     | Radsatz mit großem Gewicht<br>Wheel set with large weight     | 116387              | 12                           |
| 17                     | Radsatz mit mittlerem Gewicht<br>Wheel set with middle weight | 116388              | 12                           |
| 18                     | Vorlaufgestell komplett<br>Pilo frame ass.                    | 116383              | 17                           |
| <b>AC-Wechselstrom</b> |   |                     |                              |
| 19                     | Radsatz kleines Gewicht o.Z.<br>Wheel set small weight        | 116391              | 12                           |
| 20                     | Radsatz mit mittlerem Gewicht<br>Wheel set with middle weight | 116392              | 12                           |
| 21                     | Radsatz mit großem Gewicht<br>Wheel set with large weight     | 116393              | 12                           |
| 22                     | Radsatz mit mittlerem Gewicht<br>Wheel set with middle weight | 116394              | 12                           |
| 23                     | Vorlaufgestell komplett<br>Pilo frame ass.                    | 116390              | 17                           |
| 24                     | Vorlaufradsatz<br>Wheelset                                    | 116395              | 9                            |

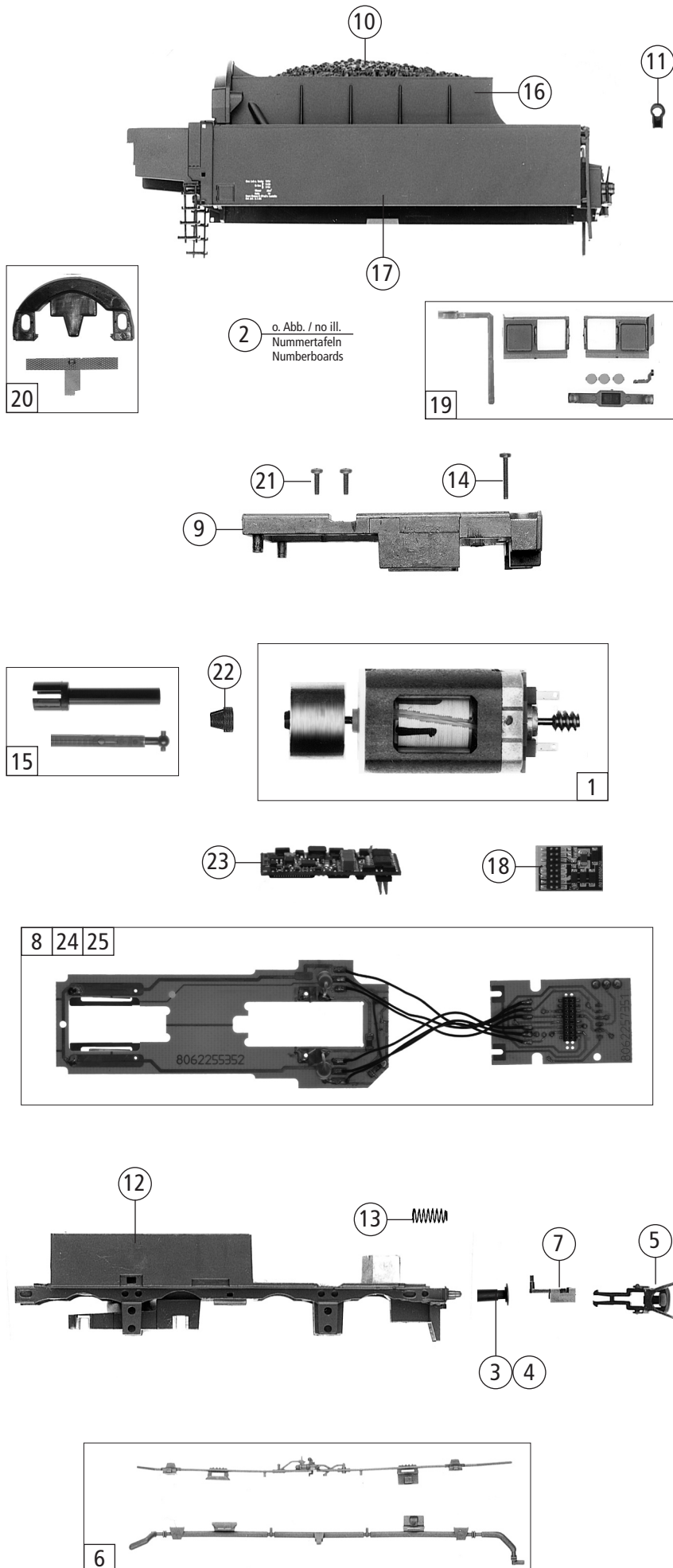

| Pos. Nr.<br>Pos.no.    | Beschreibung<br>Description   | Art.-Nr.<br>Art.no. | Preisgruppe<br>Price bracket |
|------------------------|---|---------------------|------------------------------|
| 62246                  | DB BR 50  | =                   |                              |
| 62247                  |   | =                   | 🔊                            |
| 68247                  |   | ~                   | 🔊                            |
| 1                      | Motor<br>Motor  | 85131               | 28                           |
| 2                      | Nummertafeln (Kessel u. Tender)<br>Number boards (boiler a. tender) | 133472              | 7                            |
| 3                      | Puffer flach<br>Buffer flat   | 88556               | 5                            |
| 4                      | Puffer gewölbt<br>Buffer vaulted                                    | 88557               | 5                            |
| 5                      | Standardkupplung<br>Standard coupling                               | 89246               | 6                            |
| 6                      | Tenderleitungssatz<br>Tender body assembly                          | 100166              | 7                            |
| 7                      | Kupplungskammer<br>Coupling holder                                  | 108225              | 4                            |
| 8                      | Tenderplatine kpl.<br>Tender printed printed circuit ass.           | 132976              | 24                           |
| 9                      | Tendergewicht<br>Tender weight                                      | 109405              | 8                            |
| 10                     | Kohlegewicht<br>Carbon weight                                       | 109868              | 10                           |
| 11                     | Tenderlampe oben<br>Tender lamp above                               | 112805              | 3                            |
| 12                     | Tendergrundrahmen<br>Tender frame                                   | 133470              | 16                           |
| 13                     | Bürstenfeder<br>Spring  | 114197              | 3                            |
| 14                     | GF-Schraube M1,6x10<br>GF-Screw M1,6x10                             | 114881              | 3                            |
| 15                     | Kardanwelle, Kardanhülse<br>Cardan shaft, cardan bearing            | 111765              | 4                            |
| 16                     | Kohlekasten mit Kohlegewicht<br>Coal box with coalweight            | 109816              | 10                           |
| 17                     | Tendergehäuse<br>Tender pipe  | 133471              | 20                           |
| 18                     | Brückenstecker 16Plux<br>Connector 16Plux                           | 129630              | 8                            |
| 19                     | TS-Lichtleiter<br>Part set light transmission bar                   | 100141              | 9                            |
| 20                     | Stirnteil, Trittbloch<br>Part set                                   | 100142              | 8                            |
| 21                     | GF-Schraube M1,6x5<br>GF-Screw M1,6x5                               | 115269              | 3                            |
| 22                     | Kardanschale<br>Cardanbearing                                       | 87129               | 4                            |
| <b>Sound</b>           |   |                     |                              |
| 23                     | Sounddecoder 16Plux<br>Sounddecoder 16Plux                          | 129300              | 39                           |
| 24                     | Tenderplatine kpl.<br>Tender printed circuit ass.                   | 132977              | 28                           |
| <b>AC-Wechselstrom</b> |   |                     |                              |
| 25                     | Tenderplatine kpl.<br>Tender printed circuit ass.                   | 132334              | 28                           |

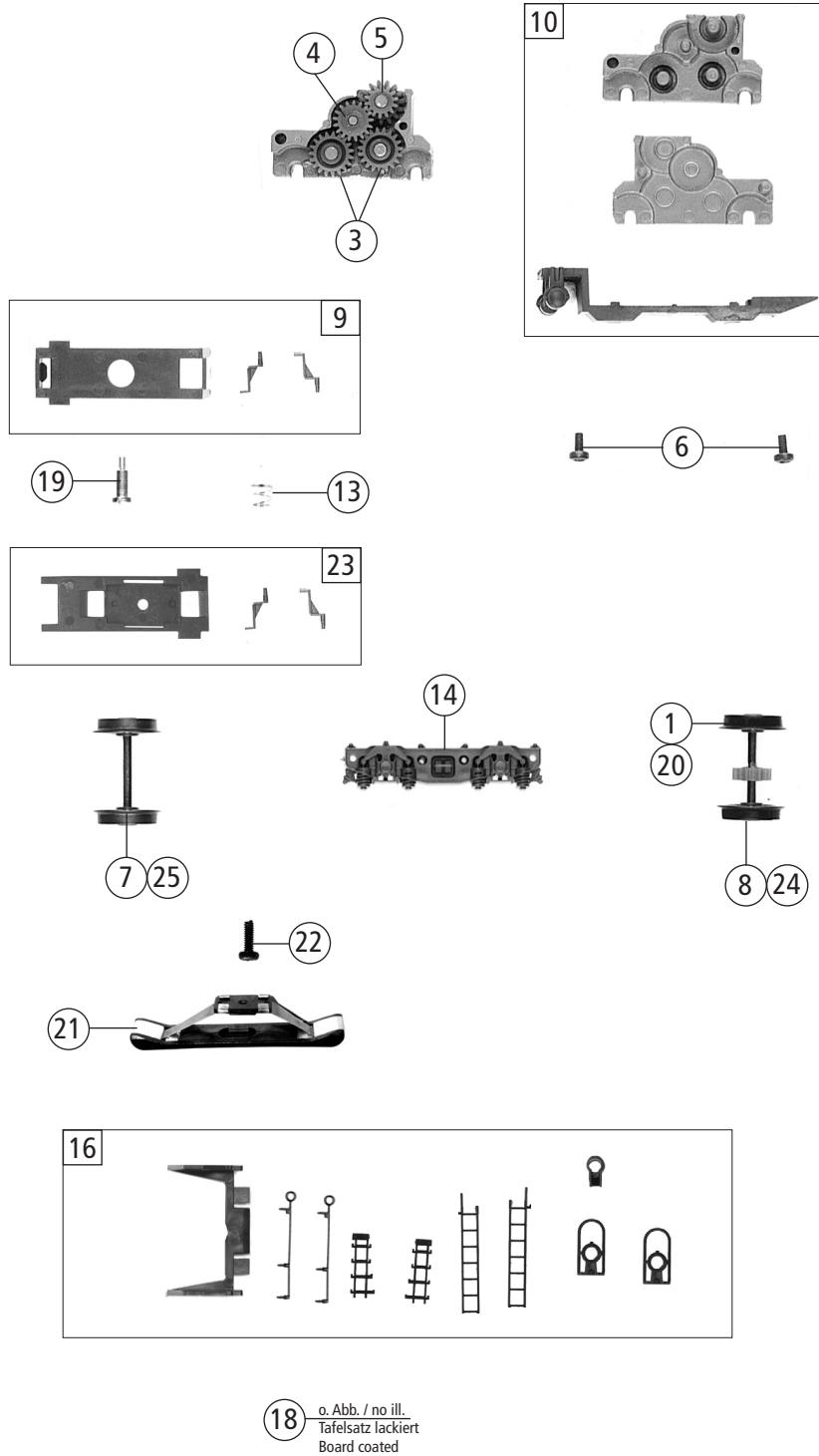

18 o. Abb. / no ill.  
Tafelsatz lackiert  
Board coated

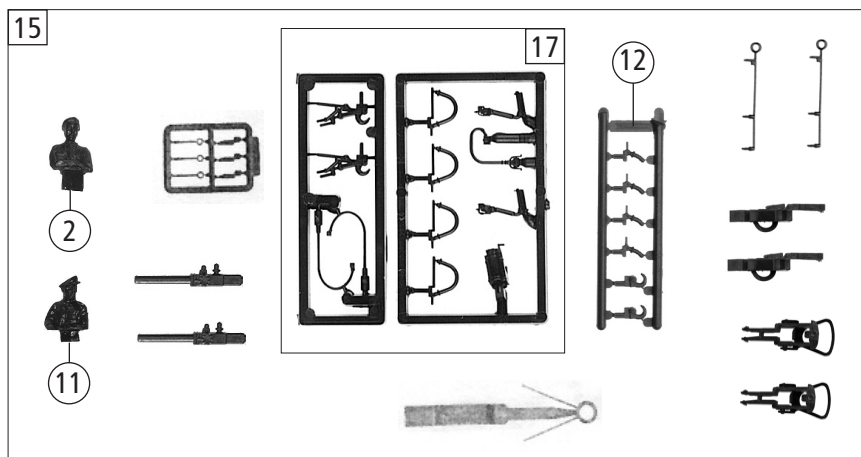

| Pos. Nr.<br>Pos.no.    | Beschreibung<br>Description                               | Art.-Nr.<br>Art.no. | Preisgruppe<br>Price bracket |
|------------------------|---|---------------------|------------------------------|
| 62246                  | DB BR 50  | =                   |                              |
| 62247                  |   | =                   | 🔊                            |
| 68247                  |   | ~                   | 🔊                            |
| 1                      | Hafrings.10Stk.10,3-12,8mm<br>Traction tires set 10pieces | 40069               | ---                          |
| 2                      | Lokführer<br>Loco driver                                  | 89724               | 6                            |
| 3                      | Zahnrad Z=19<br>Gear Z=19                                 | 86417               | 3                            |
| 4                      | Zahnrad Z=17<br>Gear Z=17                                 | 86418               | 5                            |
| 5                      | Schneckenzahnrad Z=15/14<br>Worm gear Z=15/14             | 86490               | 5                            |
| 6                      | GF -Schraube M2x4<br>GF -Screw M2x4                       | 114877              | 3                            |
| 7                      | Radsatz ohne Zahnrad<br>Wheelset without gear             | 121877              | 9                            |
| 8                      | Radsatz mit 2 Hafringen<br>Wheelset with 2 traction tires | 90690               | 11                           |
| 9                      | Teilesatz Tender<br>Parts set tender                      | 100167              | 8                            |
| 10                     | Tendergetriebe<br>Tender gear set                         | 100136              | 13                           |
| 11                     | Lokführer/Heizer<br>Loco driver/Heater                    | 89725               | 6                            |
| 12                     | Atrappenrahmen klein<br>Push in part set, smal            | 107808              | 4                            |
| 13                     | Laufgestelldruckfeder<br>Spring                           | 108226              | 3                            |
| 14                     | Blende<br>Bogie frame                                     | 108227              | 9                            |
| 15                     | Zurüstbeutel<br>Bag with accessories                      | 116371              | 15                           |
| 16                     | Teilesatz Kessel - Tender<br>Parts set boiler-tender      | 100140              | 12                           |
| 17                     | Teilesatz<br>Parts set                                    | 108322              | 7                            |
| 18                     | Tafelsatz lackiert o.Abb.<br>Board coated no ill.         | 133480              | 12                           |
| 19                     | Ansatzschraube<br>Screw                                   | 85669               | 4                            |
| <b>AC-Wechselstrom</b> |   |                     |                              |
| 20                     | Hafrings.10Stk.10,3-12,4mm<br>Traction tires set 10pieces | 40074               | ---                          |
| 21                     | Schleifer<br>Slider                                       | 86031               | 14                           |
| 22                     | GF-Schraube M1,6x5<br>GF-Screw M1,6x5                     | 115269              | 3                            |
| 23                     | TS-Tender<br>Parts set tender                             | 109929              | 8                            |
| 24                     | Radsatz mit 2 Hafringen<br>Wheelset with 2 traction tires | 109889              | 12                           |
| 25                     | Radsatz ohne Zahnrad<br>Wheelset without gear             | 108304              | 10                           |

Ersatzteile erhalten Sie bei Ihrem Fachhändler, oder Ihrer Landesvertretung:  
You can order your Replacement Parts at your local dealer, your country representative: