

Pos. Nr.	Text	Art.-Nr.	Preis-gros
1	Motor komplett <i>Motor assembly</i>	85091	57
2	Schraube 2,2 x 9,5 <i>Screw 2,2 x 9,5</i>	85799	2
3	Kardanschale kurz <i>Cardan bearing</i>	87129	3
4	Platine komplett <i>Printed circuit assembly</i>	87785	43
5	Puffer flach <i>Buffer flat</i>	88502	4
6	Puffer gewölbt <i>Buffer vaulted</i>	88503	4
7	Lokführer <i>Driver</i>	89732	5
8	Glühlampe <i>Light bulb</i>	93519	10
9	Brückenstecker für DC <i>Connector for DC</i>	100644	7
10	Gehäuse komplett Betr. Nr. 232-601-5 <i>Body assembly</i> Betr. No. 232-601-5	105736	61
11	Fenstersatz <i>Glazing set</i>	101235	10
12	Lichtleitstäbesatz <i>Light transmission bar set</i>	101236	9
13	Motorauflage <i>Motor bearing</i>	101238	3
14	Grundrahmen <i>Frame</i>	101243	30
15	Tank <i>Tank</i>	101247	15
16	Teilesatz 3 <i>Parts set 3</i>	101248	18
17	Platine komplett 43944 <i>Printed circuit assembly 43944</i>	87786	43
18	Modul 43944 <i>Modul 43944</i>	89940	-
19	Brückenstecker für AC 43944 <i>Connector for AC 43944</i>	100645	7
20	Modulschachtel 43944 <i>Modul holder 43944</i>	101251	6
21	Motor komplett 43944 <i>Motor assembly 43944</i>	85086	57

Pos. Nr.	Text	Art.-Nr.	Preisgruppe
1	Hafttring für DC Traction tyre	85612	17
2	Zahnrad z=17 / 0,4 G Gear T=17 / 0,4 G	86418	2
3	Schneckenrad für DC Gear	86419	4
4	Zahnrad Gear	86460	2
5	Zwischenzahnrad Gear	86480	2
6	Schnecke für DC Worm for DC	86704	5
7	Kardanschale Cardan bearing	87152	2
8	Universalkupplung Universalcoupling	89282	5
9	Radkontakt Wheel current contact	89956	4
10	Radsatz ohne Hafttring Wheelset without traction	90893	18
11	Radsatz mit 2 Hafttringen Wheelset with 2 traction	90894	20
12	Teilesatz 1 Part set 1	101234	28
13	Leiter Step	101237	3
14	Kontakthalter Contact holder	101239	5
15	Teilesatz 2 Parts set 2	101240	11
16	Drehgestell komplett Bogie assembly	101241	53
17	Schneckensatz Worm set	101242	24
18	Getriebebesatz Gear part set	101244	18
19	Deckel DC Cover DC	101245	5
20	Zurüstbeutel Bag with accessories	101246	26
21	Kupplungskammer Coupling holder	101452	2
22	Schleifer Collector shoe	40003	-
23	Hafttring für AC Traction tyre	85618	17
24	Schraube 1,6 x 5 Screw 1,6 x 5	85692	2
25	Schneckenrad für AC Gear for AC	86413	4
26	Schnecke für AC Worm for AC	86702	5
27	Radsatz ohne Zahnrad Wheelset without gear	90895	16
28	Radsatz m. 2 Hafttringen Wheelset with traction	90896	20
29	Drehgestell 1 komplett Bogie assembly 1	101252	56
30	Schneckensatz Worm set	101253	24
31	Deckel AC Cover AC	101254	8
32	Getriebe Gears	101255	12
33	Drehgestell 2 komplett Bogie 2 assembly	101256	49

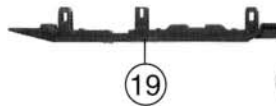

27 Abb. 19a, 11
Radsatz o. Zahnrad
Wheelset without gear

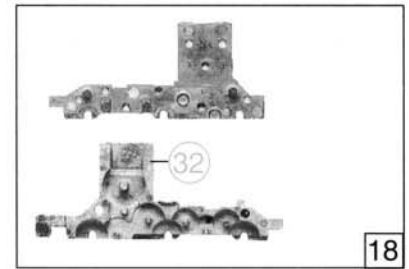
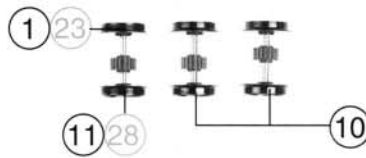
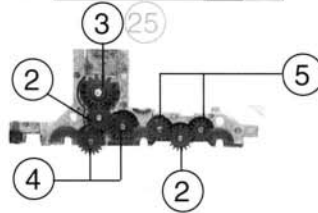
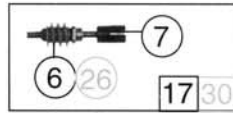
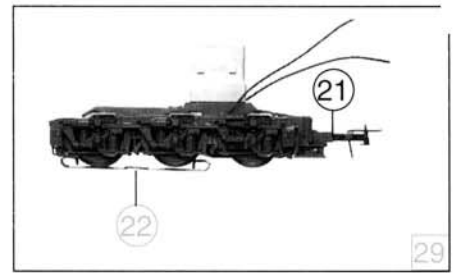
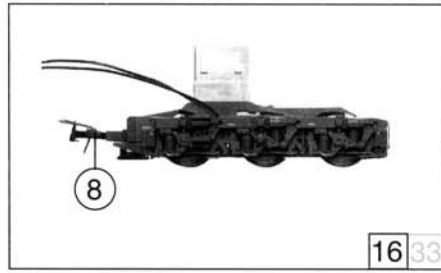
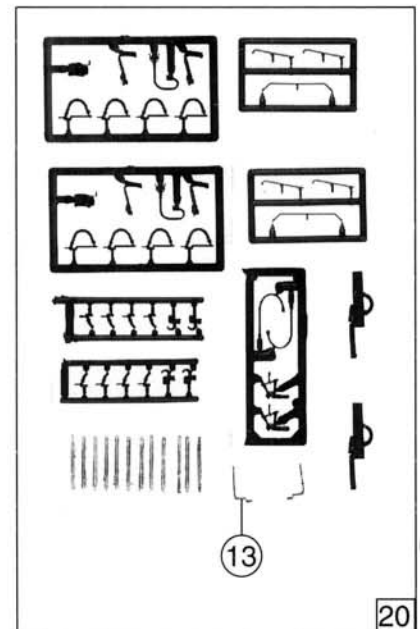
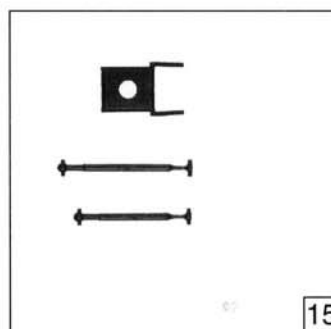

Pos. Nr.	Text	Art.-Nr.	Preis-gruppe
1	Hafring f. Dc Traction tyre	85612	17
2	Zahnrad z = 17/0,4 G Gear z = 17/0,4G	86418	2
3	Schnecken Zahnrad f. DC Gear	86419	4
4	Zahnrad Gear	86460	2
5	Zwischenzahnrad Gear	86480	2
6	Schnecke f. DC Worm f. DC	86704	5
7	Kardanschale Cardan Bearing	87152	2
8	Standardkupplung Standard coupling	89246	5
9	Radkontakt Wheel current contact	89956	4
10	Radsatz o. Hafring Wheel without traction	90893	18
11	Radsatz m. 2 Hafringen Wheelset with traction	90894	20
12	Teilsatz 1 Part set 1	101234	28
13	Leiter Step	101237	3
14	Kontakthalter Contact holder	101239	5
15	Teilsatz 2 Part Set 2	101240	11
16	Drehgestell komplett Bogie assembly	101241	53
17	Schneckensatz Worm set	101242	24
18	Getriebesatz Gear part set	101244	18
19	Deckel DC Cover DC	101245	5
20	Zurüstbeutel Bag with accessoires	101246	26
21	Kupplungskammer Coupling holder	101452	2
22	Schleifer Collector shoe	40003	-
23	Hafring f. AC Traction tyre	85618	17
24	Schraube 1,6 x 5 Screw 1,6 x 5	85692	2
25	Schnecken Zahnrad f. AC Gear f. AC	86413	4
26	Schnecke f. AC Worm f. AC	86702	5
27	Radsatz o. Zahnrad Wheelset without gear	90895	16
28	Radsatz m. 2 Hafringen Wheelset with traction	90896	20
29	Drehgestell 1 Bogie assembly 1	101252	56
30	Schneckensatz Worm set	101253	24
31	Deckel AC Cover AC	101254	8
32	Getriebe Gears	101255	12
33	Drehgestell 2 Bogie assembly 2	101256	49

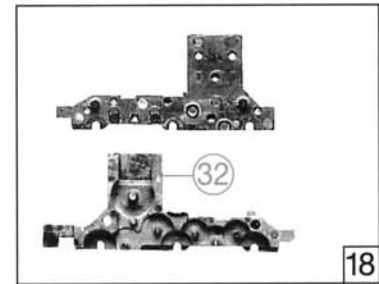
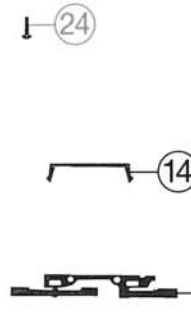
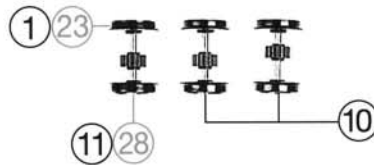
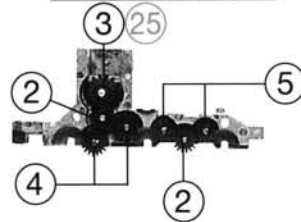
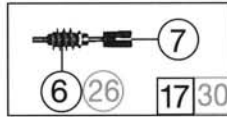
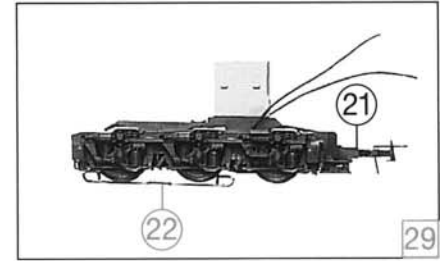
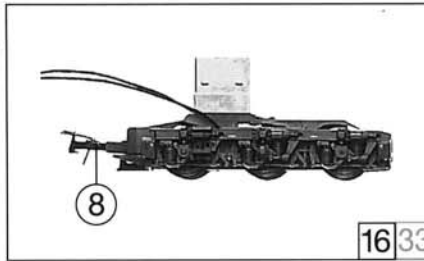

27
o. Abb. / no. ill.
Radsatz o. Zahnrad
Wheelset without gear

