

51222		DBAG BR 294	=	□□
Pos. Nr. Pos. no.	Beschreibung Description	Art.-Nr. Art. no.	Preisgruppe Price bracket	
1	Motor Motor	85009	27	
2	Schraube M2x6 Screw M2x6	85672	3	
3	Kardanschale 8,0mm Cardan bearing 8,0mm	87152	3	
4	GF - Schraube 2x6 GF - Screw 2x6	114828	3	
5	Linse Lens	93994	3	
6	Drahtlampe Wire lamp	108616	8	
7	Fenstersatz Window set	114494	10	
8	Platine kpl. Printed circuit assembly	116721	21	
9	Grundrahmen Base frame	114503	19	
10	Kabine komplett Cab assembly	134600	20	
11	Gehäuse Betr.nr. 294 207-6 Body no. 294 207-6	134599	17	
12	Dachlüfter Roof lifter	107631	3	
13	Rauchfang Chimney	107632	4	
14	TS - Antenne, Funkkast. Part set antenna, radio box	114507	6	
15	Sirene 1 Airhorn 1	114508	3	
16	Sirene 2 Airhorn 2	114509	3	
17	Dach Roof	115073	8	
18	Decoder 8-polig Decoder 8-polig	10884	---	

Änderungen in Konstruktion und Ausführung vorbehalten
We reserve the right to change the construction and specification

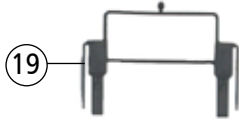

14 o. Abb. / no ill.
Bühne kpl.
Plattform assembly

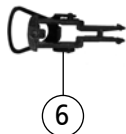
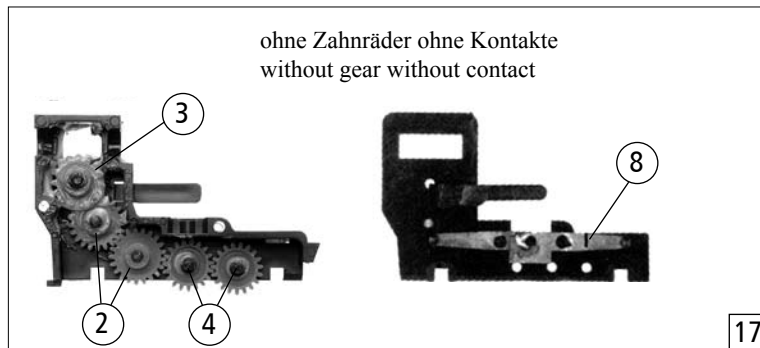
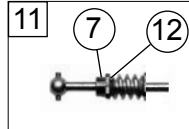
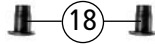

Pos. Nr. Pos. no.	Beschreibung Description	Art.-Nr. Art. no.	Preisgruppe Price bracket
1	Haftringsatz 10 Stk. 12,5-13,8mm Traction tieres 10 pieces	40066	---
2	Zahnrad Z=21 G/M=0,4 Gear t=21	86414	3
3	Schnecken Zahnrad 15/14 Worm gear	86490	5
4	Zahnrad Z=19/1,4G Gear t=19/1,4G	86493	3
5	Kardanwelle Cardan shaft	87214	5
6	Standardkupplung Standard coupling	89246	6
7	Lager für Schneckenachse Worm axle bearing	89749	3
8	Radkontakt Wheel contact	89804	3
9	Radsatz o. Haftring Wheelset without traction tyre	111124	11
10	Radsatz mit 2 Haftringen Wheelset with 2 traction tieres	111125	12
11	Schneckensatz Worm set	111307	13
12	Anlaufscheibe Washer	114622	3
13	Kammerdeckel Chamber cap	115070	4
14	Bühne komplett Plattform assembly	114504	13
15	Blende ohne Leiter Bogie without ladder	134589	9
16	Kupplungskammer Coupling chamber	115069	4
17	Getriebekasten u. Getriebedeckel Gear case a. gear cover	112820	9
18	Puffer Buffer	105825	3
19	Reflektor mit Griff Reflektor	114510	4