

- 02156S-A01 Gehäuse komplett
- 02156S-004 Seitenfenster
- 02156S-A01 Body assembly
- 02156S-004 Side window

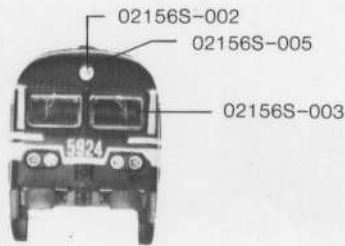

- 02156S-002 Dach
- 02156S-003 Kabinenfenster
- 02156S-005 Oberer Lichtleitstab
- 02156S-002 Roof
- 02156S-003 Cab window
- 02156S-005 Upper light transmission bar

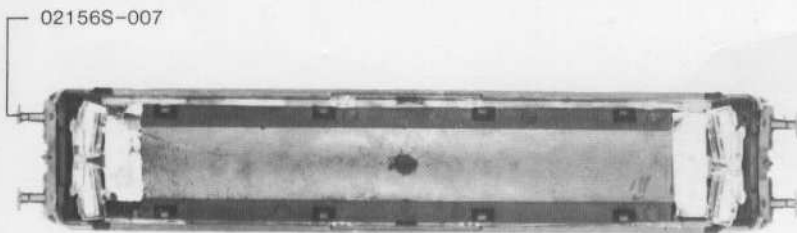

- 02156S-007 Puffer
- 02156S-007 Buffer



- 02150S-22A Kontaktplatte kompl.
- 04572S-001 Glühlampe
- 02150S-22A Printed circuit assembly
- 04572S-001 Electric lamp

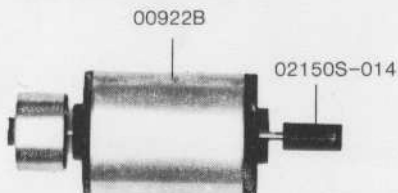

- 00922B Motor komplett mit Wuchtrad
- 02150S-014 Antriebsbuchse
- 00922B Motor assembly with flywheel
- 02150S-014 Male shaft



- 02150S-027 Gummibettung
- 02150S-039 Scheibe
- 02150S-040 Schraube M2x4
- 02150S-027 Rubber embedding
- 02150S-039 Washer
- 02150S-040 Screw M2x4



- 02150S-010 Halter
- 02150S-006 Werkzeugkasten
- 02150S-018 Gewicht
- 02150S-010 Holder
- 02150S-006 Toolcase
- 02150S-018 Ballast weight

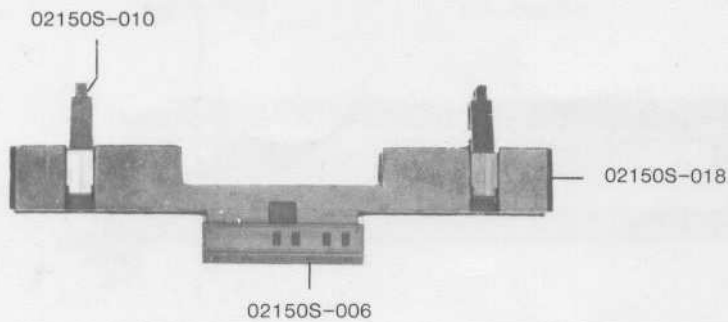

- 02156S-A02 Drehgestell kompl.
- 03237S Kupplung
- 03159S-005 Rahmen
- 02150S-021 Drehgestell-Boden
- 02156S-900 Ersatzteileblatt
- 02156S-A02 Truck assembly
- 03237S Coupling
- 03159S-005 Truckframe
- 02150S-021 Truckframe-base
- 02156S-900 Service parts list

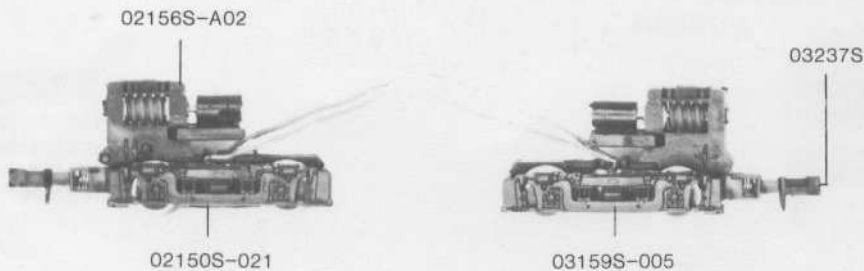

- 02150S-011 Klemme
- 02150S-012 Gelenkschale
- 02150S-013 Gelenk
- 02150S-015 Zahnrad Z=15
- 03152S-015 Kontakt
- 03152S-020 Schneckenlager
- 03158S-001 Schnecke
- 03158S-003 Zahnrad Z=11
- 03158S-004 Zahnrad Z=11
- 03158S-011 Schneckendeckel
- 02150S-011 Clamp
- 02150S-012 Male shaft shell
- 02150S-013 Male shaft
- 02150S-015 Gear T=15
- 03152S-015 Wheel wipper
- 03152S-020 Worm bearing
- 03158S-001 Worm
- 03158S-003 Gear T=11
- 03158S-004 Gear T=11
- 03158S-011 Worm cover

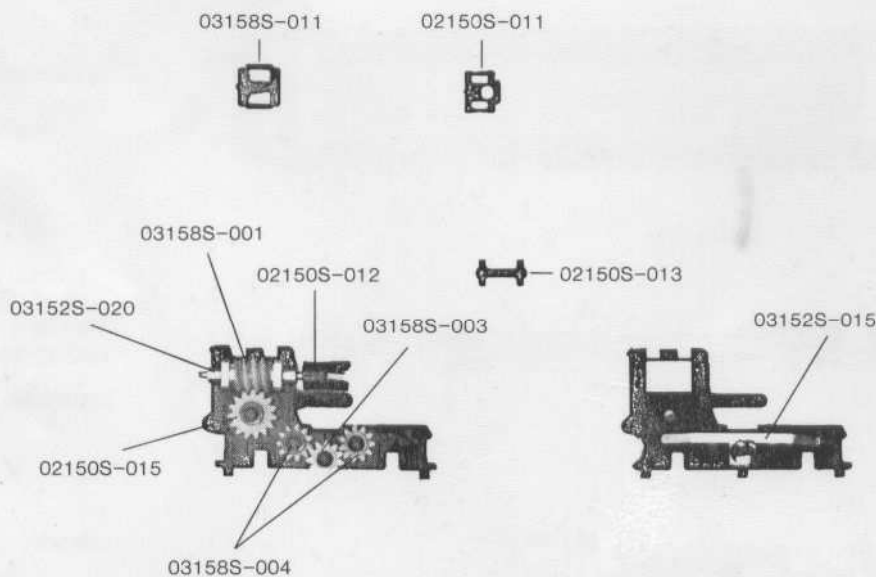

- 02150S-19A Laufradsatz
- 02150S-34A Haftringradsatz
- 02150S-033 Haftring
- 02150S-19A Wheelset assembly
- 02150S-34A Traction tyre set
- 02150S-033 Traction tyre

