

Symbolische Darstellung
Symbolic illustration

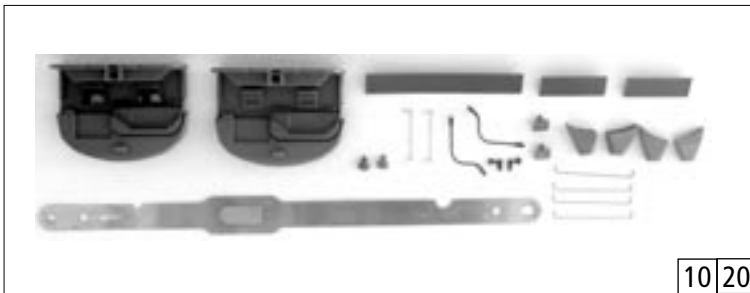

5 12 13 14 22 23

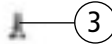
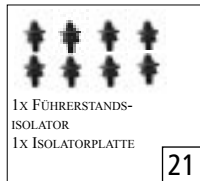
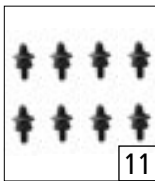
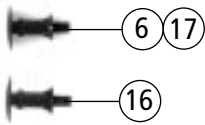

10 20

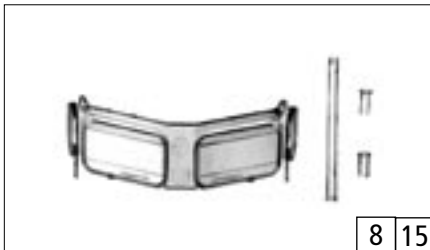

8 15



9 18



24

63890	FS E. 444		
69890	FS E. 444	~	
63891	FS E. 444 R		
69891	FS E. 444 R	~	

Pos. Nr. Pos.no.	Beschreibung Description	Art.-Nr. Art.no.	Preisgruppe Price bracket
1	Pantograph rot Pantograph red Pantografo rosso	85265	38
2	Lokpfeife Loko whistle Fischio della locomotive	88002	2
3	Schraube M2x5 Screw M2x5 Vite M2x5	85671	2
4	Lichtring groß Light ring large Ghiera fanale grande	120066	2
5	Gehäuse komplett Betr. Nr. E. 444. 019 Body assembly loco no. E. 444. 019 Carrozzeria completa E. 444. 019	120088	73
6	Puffer gewölbt brüniert Buffer vaulted browned Respingente bombato brunito	120094	3
7	Lichtring klein Light ring small Ghiera fanale piccola	120097	2
8	TS - Fenster 1 Part set window 1 Set finestrini 1	120098	17
9	TS - Fenster 2 Part set window 2 Set finestrini 2	120099	16
10	TS - Gehäuse Part set body Carrozzeria n° di servizio	120100	31
11	TS - Isolatoren Part set insulators Set isolatori	120101	17
12	Gehäuse komplett Betr. Nr. E. 444. 043 Body assembly loco no. E. 444. 043 Carrozzeria completa E. 444. 043	120224	73
13	Gehäuse komplett Betr. Nr. E. 444. 050 Body assembly loco no. E. 444. 050 Carrozzeria completa E. 444. 50	120225	73
Abweichende Teile 63891/69891			
14	Gehäuse kopmplett Betr. Nr. E. 444. 008 Body assembly loco no. E. 444. 008 Carrozzeria completa E. 444. 008	120054	73
15	TS - Fenster 1 Part set window 1 Set finestrini 1	120056	19
16	Puffer links Buffer left Respingente Respingente sinistro	120057	2
17	Puffer rechts Buffer right Respingente destro	120058	2
18	TS - Fenster 2 Part set window 2 Set finestrini 2	120059	21
19	Pantograph Pantograph Pantografo	85414	38
20	TS - Gehäuse Part set body Particolari carrozzeria	120069	30
21	TS - Isolatoren Part set insulators Set isolatori	120070	19
22	Gehäuse komplett Betr. Nr. E. 444. 042 Body assembly loco no. E. 444. 042 Body assembly loco no. E. 444. 042	120238	73
23	Gehäuse komplett Betr. Nr. E. 444. 048 Body assembly loco no. E. 444. 048 Body assembly loco no. E. 444. 048	120319	73
~ Wechselstrom AC			
24	Decoder Motorola m. Lastr. last. Decoder Motorola Decoder Motorola con regolazione di carico	10738	---

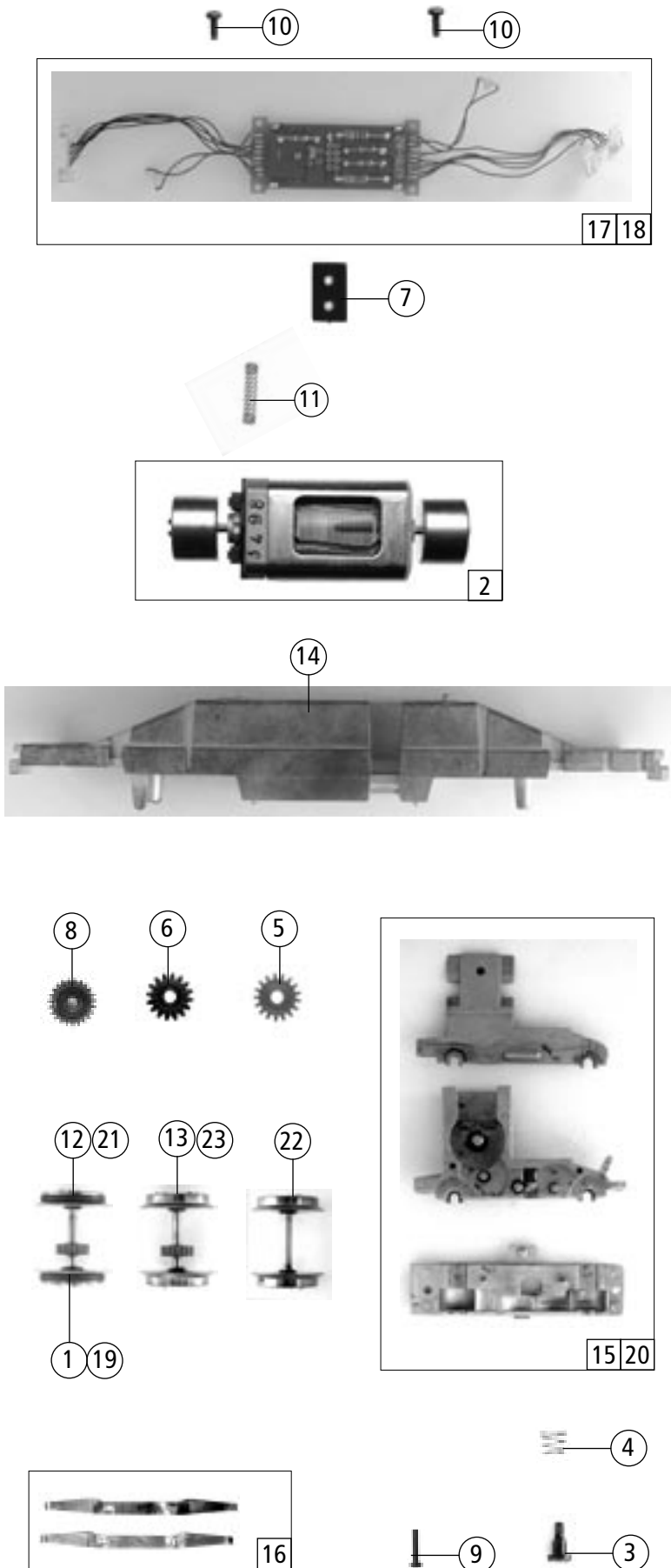

63890	FS E. 444		
69890	FS E. 444	~	
63891	FS E. 444 R		
69891	FS E. 444 R	~	
Pos. Nr. Pos.no.	Beschreibung Description	Art.-Nr. Art.no.	Preisgruppe Price bracket
1	Hafringsatz 10 Stk. Traction tires set 10 piece Set anelli di aderenza 10 pezzi	40070	---
2	Motor Motore	85112	57
3	FK - Schraube M2x4,5/7,5 FK - Screw M2x4,5/7,5 FK - Vite M2x4,5/7,5	85756	2
4	Feder Spring Molla di trazione	86202	2
5	Zahnrad Z 17/0.4 Gear Z 17/0.4 Ruota dentata Z 17/0.4	86418	2
6	Schneckenzahnrad doppelt Worm gear double Ingranaggio doppio	86419	4
7	Brückenstecker Connector Connettore	100644	7
8	Zahnrad Z 23/M0,4 Gear Z 23/M0,4 Ruota dentata Z 23/M0,4	111679	2
9	GF - Schraube 1,6x6 Screw 1,6x6 GF - Vite 1,6x6	114836	2
10	GF - Schraube M2x5 GF - Screw M2x5 GF - Vite M2x5	114966	2
11	Kontaktfeder Spring Molla di trazione	116876	2
12	Radsatz mit Haftreifen Wheelset with traction tires Assale cerchioni	120103	20
13	Radsatz ohne Haftreifen Wheelset without traction tires Assale senza cerchioni	120104	18
14	Grundrahmen Base frame Telaio	120050	26
15	TS - Getriebe Gear set Aredamento telaio portganci	120055	19
16	TS - Radkontakte Part set wheel contact Lamella di contatto ruote	120071	7
17	Platine komplett mit LED's Printed circuit assembly Circuito stampato	120090	40
Abweichende Teile 63891/69891			
18	Platine komplett mit LED's Printed circuit assembly Circuito stampato	120051	40
~ Wechselstrom 69890/69891			
19	Hafringsatz 10 Stk. Traction tires set 10 piece Set anelli di aderenza 10 pezzi	40075	---
20	TS - Getriebe mit Boden f. Schleifer Gear set Aredamento telaio portganci	120060	19
21	Radsatz mit Haftreifen Wheelset with traction tires Assale cerchioni	120063	20
22	Radsatz ohne Haftreifen o. Zahnrad Wheelset without gear Assale senza ruota dentata	120064	16
23	Radsatz ohne Haftreifen Wheelset without traction tires Assale senza cerchioni	120065	18

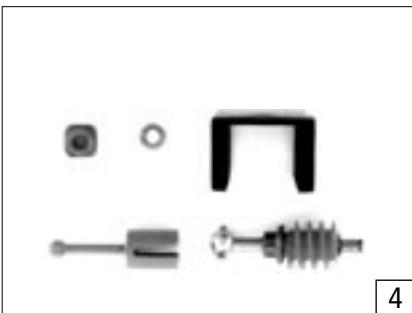
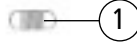
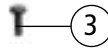
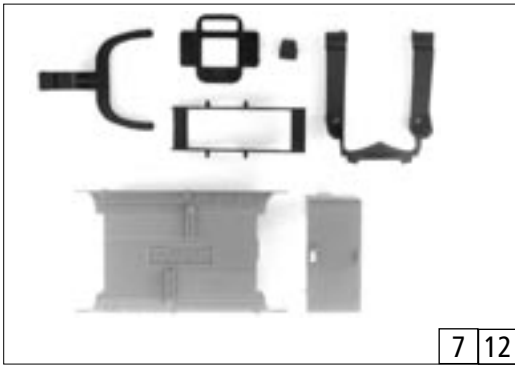

8 9 o. Abb. / no ill.
Zurüstbeutel
Bag with accessories
Busta accessori

Pos. Nr. Pos.no.	Beschreibung Description	Art.-Nr. Art.no.	Preisgruppe Price bracket
63890	FS E. 444		
69890	FS E. 444	~	
63891	FS E. 444 R		
69891	FS E. 444 R	~	
1	Zugfeder Spring Molla di trazione	86208	2
2	Standardkupplung Standard coupling Gancio standard	89246	5
3	GF - Schraube M2x6 Screw M2x6 GF - Vite M2x6	114828	2
4	TS - Antrieb Part set drive Aredamento Motore	120053	19
5	TS - Drehgestell 1 Part set bogie 1 Carrello 1	120067	21
6	TS - Drehgestell 2 Part set bogie 2 Carrello 2	120068	21
7	TS - Unterboden Part set bottom Particolari carrozzeria inferiori	120102	19
8	Zurüstbeutel ohne Abbildung Bag with accessories no ill. Busta accessori, senza ill.	120089	21
Abweichende Teile 63891/69891			
9	Zurüstbeutel ohne Abbildung Bag with accessories no ill. Busta accessori, senza ill.	120052	22
~ Wechselstrom AC			
10	Schleifer kurz Collector short Pattino corto	40500	---
11	Schraube 1,6x5 Screw 1,6x5 Vite 1,6x5	115317	2
12	TS - Unterboden Part set bottom Particolari carrozzeria inferiore	120061	19